

## **ATTACHMENT 6**

---



### **TEST PIT LOGS**



Major Divisions		Symbols	Typical Names
Coarse Grained Soils (More than 1/2 of soil > No. 200 sieve size)	Gravels (More than 50% coarse fraction > no. 4 sieve)	GW	Well-graded gravels or gravel-sand mixtures, little to no fines
		GP	Poorly-graded gravels or gravel-sand mixtures, little to no fines
		GM	Silty gravels, gravel-sand-silt mixtures
		GC	Clayey gravels or gravel-sand-clay mixtures
	Sands (Less than 50% coarse fraction > no. 4 sieve)	SW	Well-graded sands or gravel-sand mixtures, little to no fines
		SP	poorly-graded sands or gravelly sands, little to no fines
		SM	Silty sands, sand-silt mixtures
		SC	Clayey sands, sand-clay mixtures
Fine Grained Soils (More than 1/2 of soil < No. 200 sieve size)	Sils & Clays Liquid limit* less than 50%	ML	Inorganic silts and very fine sands, silty or clayey fine sands or clayey silts with slight plasticity
		CL	Inorganic clays of low to medium plasticity, gravelly clays, sandy or silty clays, lean clays
		OL	Organic silts and organic silty clays of low plasticity
	Sils & Clays Liquid limit* greater than 50%	MH	Inorganic silts, micaceous or ditomaceous fine sand or silty soils, elastic silts
		CH	Inorganic clays of high plasticity, fat clays
		OH	Organic clays of medium to high plasticity, organic silty clay, organic silts
Highly Organic Soils	Pt	Peat or other highly organic soils	

\*Liquid limit represents the moisture content (in percent) of a soil at which point the soil no longer behaves like a plastic and starts to behave like a liquid.

### Boring Log Symbols

-  Sample Interval
-  Groundwater, First Observed
-  Groundwater, Static

### Sample Types

- SS Split Spoon
- G Grab
- ST Shelby Tube
- GS Geoprobe Sampler

### Sheen Types

- NS No Sheen Observed
- SS Slight Sheen observed (Spotty coverage of sheen pan, no)
- MS Moderate Sheen (Full Coverage)
- HS Heavy Sheen (Full Coverage, Irresdescent)

### Sample Moisture

- Dry No Moisture, dry to touch
- Moist Damp but no visible moisture
- Wet Visible free water

### Sample Plasticity (Fine-Grained Soils)

- Non-Plastic - Cannot be rolled at any moisture content
- Low - Barely rolled, lump cannot be formed when drier than plastic limit
- Medium - Easily rolled, lump crumbles when drier than plastic limit
- High - Easily rolled yet takes considerable time to reach the plastic limit, lump can be formed without crumbling when drier than the plastic limit

### Partical Size Range (Course-Grained Soils)

- Gravel - Fine, Course
- Sand - Fine, Medium, Coarse

Integral Consulting, Inc.  
2817 NE 22nd Avenue  
Portland, Oregon 97212  
503-284-5545  
503-284-5755 (Fax)

Based on Unified Soil Classification System and ASTM Standard D2487 and D2488



1201 Cornwall Avenue, Suite 208  
Bellingham, WA 98225

(360) 756-9296 FAX (360) 756-7914

TEST PIT NUMBER TP-1  
PROJECT Little Squalicum Park RI/FS  
LOCATION Bellingham, Washington  
PROJECT NUMBER C075-02  
LOGGED BY M. Herrenkohl, P.E.G.  
DATE November 9, 2005

SAMPLE INFORMATION					Depth (ft)	STRATA	DESCRIPTION
Sample ID	Sample Time	FID (ppm)	Sheen	Sample Depth (ft)			
LSP0059	1435	1.4	NS	0-1	GM/SM	Sandy gravel w/fines, light brown, some earthworms observed (fill).	
LSP0060*	1440			0-1			
LSP0061	1450	3.3	NS	1-2	Debris	Black layer, burnt garbage ash, metal debris, bones (fill).	
LSP0062	1455	2.3	LS	2-3			Orange (rusted) with white (ash) layer, garbage odor (fill).
LSP0063	1447	2.8	LS	3-4	Debris	Black layer similar to above with metal parts, bottles, and glass (fill).	
LSP0064	1445	9.5	NS	4-5			Orange layer, clays/sand/gravel matrix, similar to above with less debris (fill).
*Duplicate					4-	GM	Silty sandy fine to coarse gravel w/clay, gray (10 YR 6/1 - 5/1), 65-70% gravel.
							Bottom of test pit at 5' bgs.

**ADDITIONAL NOTES / SKETCHES**

Samples collected from west and south side walls.  
Materials encountered from 1' to 4' bgs appear to be municipal landfill materials in a soil matrix with a "garbage odor".  
Landfill materials decrease from 3-4' bgs, and are absent below 4' bgs.

EXCAVATING CONTRACTOR	Wilder Construction
EXCAVATION METHOD	Backhoe - John Deere 310
SAMPLING EQUIPMENT	Stainless Steel Spoon/Shovel/Bowl
COORDINATES	Northing: 649016.90 ft Easting: 1235609.38 ft
SURFACE ELEVATION	38.24 ft
DATUMS	Horizontal: NAD 83/91 Vertical: NAVD 88

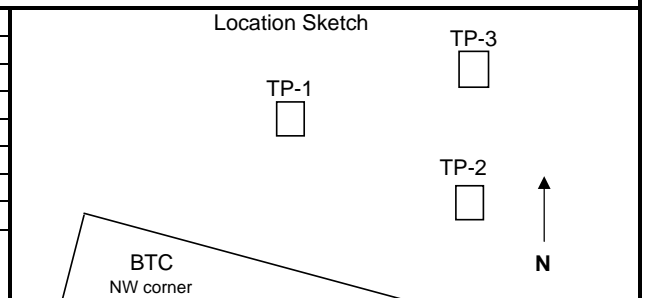



1201 Cornwall Avenue, Suite 208  
Bellingham, WA 98225

(360) 756-9296 FAX (360) 756-7914

TEST PIT NUMBER TP-2  
PROJECT Little Squalicum Park RI/FS  
LOCATION Bellingham, Washington  
PROJECT NUMBER C075-02  
LOGGED BY M. Herrenkohl, P.E.G.  
DATE November 10, 2005

SAMPLE INFORMATION					Depth (ft)	STRATA	DESCRIPTION
Sample ID	Sample Time	FID (ppm)	Sheen	Sample Depth (ft)			
LSP0065	0830	**	NS	0-1	2--	GM	Sand/gravel/clay/silt matrix, reddish dark brown (5YR 3/2), no odor (fill).
LSP0066*	0840			0-1		Debris	Black ash/burned materials mixed into similar matrix observed above.
LSP0067	0850	**	NS	1-1.6	2--	Debris	Rust zone with metal debris in a silty sand matrix, some white material of unknown source and large piece of concrete.
LSP0071	1000	**	NS	1.6-2.9		GM	Clayey sandy gravel w/silt, dark brown (7.5 YR 3/2) (fill).
LSP0070	0950	**	NS	2.9 - 3.7	4--	Debris	As above, mixed with black ashy material (fill).
LSP0069	0940	**	LS	3.7- 4.2		G	Gravel w/fines, tan to light brown (10 YR 5/2 - 5/3) (Fill?)
LSP0068	0855	**	NS	4.2- 5.3			
*Duplicate							
**Problems calibrating PID/FID							Bottom of test pit at 5.3 ft bgs.

ADDITIONAL NOTES / SKETCHES

Large 1 ft x 1 ft concrete "block" observed at approximately 2 - 2.5 ft bgs.  
Chrome stripping from car was observed at approximately 2 ft bgs.  
No municipal waste was observed in the test pit.

EXCAVATING CONTRACTOR	Wilder Construction
EXCAVATION METHOD	Backhoe - John Deere 310
SAMPLING EQUIPMENT	Stainless Steel Spoon/Shovel/Bowl
COORDINATES	Northing: 648930.22 ft Easting: 1235708.04 ft
SURFACE ELEVATION	40.61 ft
DATUMS	Horizontal: NAD 83/91 Vertical: NAVD 88

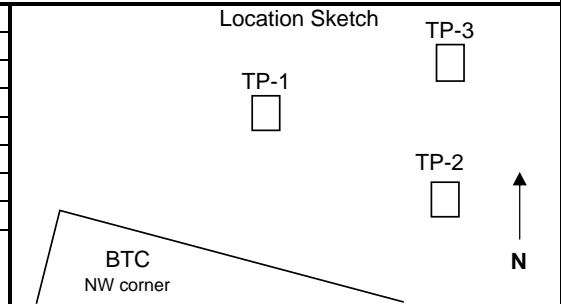



1201 Cornwall Avenue, Suite 208  
Bellingham, WA 98225

(360) 756-9296 FAX (360) 756-7914

TEST PIT NUMBER TP-3  
PROJECT Little Squalicum Park RI/FS  
LOCATION Bellingham, Washington  
PROJECT NUMBER C075-02  
LOGGED BY M. Herrenkohl, P.E.G.  
DATE November 10, 2005

SAMPLE INFORMATION						Depth (ft)	STRATA	DESCRIPTION
Sample ID	Sample Time	FID (ppm)	Sheen	Sample Depth (ft)				
LSP0075	1300	**	NS	0-1	2--	CL	Silty clay with gravel and sand to gravelly silty clay with sand, dark brown, (7.5 YR 3/4), (fill).	
LSP0074	1250	**	NS	1-2			Sand and gravel content increasing with depth.	
LSP0073	1240	**	NS	2-3	4--	GM GM/GP	Clayey silty sandy gravel, dark brown (7.5 YR 3/2), fines decreasing with depth.	
LSP0072	1230	**	NS	>3			Grading to sandy gravel w/ silt, grayish brown (10YR 5/2), 80% gravel, 20% sand, >5% fines (Native?). Bottom of test pit at 3 ft bgs.	
**Problems calibrating PID/FID								
No obvious odors								

ADDITIONAL NOTES / SKETCHES

Scrap metal (rusted bucket) observed at ~1 ft bgs.

Note: This station was moved 54 ft 060° (magnetic north) from its surveyed location. N 48.7672°, W 122.51147°.

EXCAVATING CONTRACTOR	Wilder Construction
EXCAVATION METHOD	Backhoe - John Deere 310
SAMPLING EQUIPMENT	Stainless Steel Spoon/Shovel/Bowl
COORDINATES	Northing: 649053.78 ft Easting: 1235712.67 ft
SURFACE ELEVATION	38.42 ft
DATUMS	Horizontal: NAD 83/91 Vertical: NAVD 88

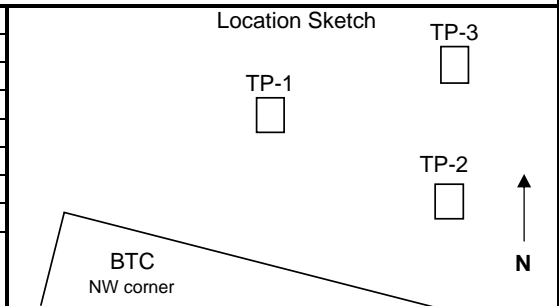



1201 Cornwall Avenue, Suite 208  
 Bellingham, WA 98225  
 (360) 756-9296 FAX (360) 756-7914

TEST PIT NUMBER TP-4  
 PROJECT Little Squalicum Park RI/FS  
 LOCATION Bellingham, Washington  
 PROJECT NUMBER C075-02  
 LOGGED BY M. Herrenkohl, P.E.G.  
 DATE November 9, 2005

SAMPLE INFORMATION						Depth (ft)	STRATA	DESCRIPTION
Sample ID	Sample Time	FID (ppm)	Sheen	Sample Depth (ft)				
LSP0055	1115	3.4**	NS	0-1	2--	GM	Silty Sandy Gravel w/clay: Brown (7.5YR 4/2), 15-20% fines, 25% sand, 60-70% gravel, mottled brown, yellow, and gray, moist. Organic-rich zone	
LSP0056	1125	14**	NS	1-2		0.25 to 0.5 ft bgs.		
LSP0057	1135	4.2**	NS	2-3		CL/GM	-zones of mottled clay and silty sandy gravel 1.5 to 2.0 ft bgs. Clay and large gravel/cobbles increase w/depth.	
LSP0058	1145	1.7**	NS	3		SM/SP	Silty sand to Sand w/silt: mottled yellow/red/brown (generally 5YR 4/6), damp to moist, moisture content increasing with depth, no odor.	
						4--		Test pit sampled and logged to 3 ft bgs and excavated to 8 ft bgs. No clay layers encountered from 3-8 ft bgs; scattered gravels observed at 8 ft bgs.
**Readings may not be accurate due to malfunctioning FID / PID meter.								

**ADDITIONAL NOTES / SKETCHES**

No obvious fill materials observed  
 Samples collected from northeast corner of the excavation.  
 Heterogeneity observed in test pit from side wall to side wall  
 Clay material in upper 2 ft varies in thickness by location within the test pit

EXCAVATING CONTRACTOR	Wilder Construction	
EXCAVATION METHOD	Backhoe - John Deere 310	
SAMPLING EQUIPMENT	Stainless Steel Spoon and Bowl	
COORDINATES	Northing: 649316.98 ft Easting: 1235338.57 ft	
SURFACE ELEVATION	40.57 ft	
DATUMS	Horizontal: NAD 83/91 Vertical: NAVD 88	



1201 Cornwall Avenue, Suite 208  
Bellingham, WA 98225

(360) 756-9296 FAX (360) 756-7914

TEST PIT NUMBER TP-5  
PROJECT Little Squalicum Park RI/FS  
LOCATION Bellingham, Washington  
PROJECT NUMBER C075-02  
LOGGED BY M. Herrenkohl, P.E.G.  
DATE November 9, 2005

SAMPLE INFORMATION					Depth (ft)	STRATA	DESCRIPTION
Sample ID	Sample Time	PID (ppm)	Sheen	Sample Depth (ft)			
LSP0050	0910	1.7	NS	0-1	2--	GM	Silty sandy gravel, dark brown (7.5YR 3/3), 15% fines, 50-60% F-C gravel, 25-35% F-Msand, vegetative cover, damp to moist.
LSP0052	0915	3.2	NS	1-2			As above w/color (7.5YR 4/2).
LSP0053	0920	5.1	NS	2-3			Increasing clay content.
LSP0054	0925	4	NS	3			Silty sand/silty gravel, gray (7.5 YR 4/1) compressed layer.
						SM /SP	Silty F-M sand to F-M sand w/silt, mottled yellow brown (10 YR 5/6).
					4--		Gray clay (mottled) observed in test pit spoils at 6.5 ft bgs.
							Bottom of test pit at 6.5 ft bgs.

**ADDITIONAL NOTES / SKETCHES**

Scattered worms and natural wood debris observed.  
A few cobble size rocks in the upper 2 ft bgs (primary).  
No sign of sheen or odor (earthy only).  
Samples collected from the north and west excavation side walls.  
No obvious fill materials observed.

EXCAVATING CONTRACTOR	Wilder Construction
EXCAVATION METHOD	Backhoe - John Deere 310
SAMPLING EQUIPMENT	Stainless Steel Spoon and Bowl
COORDINATES	Northing: 649122.32 ft Easting: 1235209.15 ft
SURFACE ELEVATION	33.40 ft
DATUMS	Horizontal: NAD 83/91 Vertical: NAVD 88

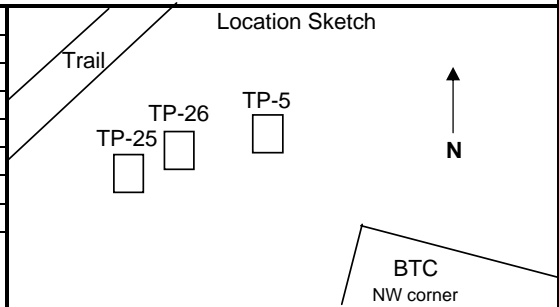



1201 Cornwall Avenue, Suite 208  
Bellingham, WA 98225

(360) 756-9296 FAX (360) 756-7914

TEST PIT NUMBER TP-6  
PROJECT Little Squalicum Park RI/FS  
LOCATION Bellingham, Washington  
PROJECT NUMBER C075-02  
LOGGED BY M. Herrenkohl, P.E.G.  
DATE November 8, 2005

SAMPLE INFORMATION						Depth (ft)	STRATA	DESCRIPTION
Sample ID	Sample Time	PID (ppm)	Sheen		Sample Depth (ft)			
LSP044	1510	4**	MS		0-1	GW	Vegetation overlying gravel "matrix" with cresoted wood debris, sheen, strong odor (fill).	
LSP0045	1515	-	HS		1-2		SM	Sand with gravel and fines, dark brown (2.5Y5/1), some NAPL, heavy sheen, damp to moist, strong creosote-like odor.
LSP0046	1610	1**	HS		2-3	OH	As above with color brown (7.5YR 4/3), wet at 2.8 ft bgs.	
LSP0047	1630	1**	HS		3-4		OH	Grading to orgainc clay with silt, mottled red/gray (10YR 4/2 to 7.5YR 4/3), medium plasticity, wet (native?).
LSP0048	1640	0**	NS		>4		Gray silty clay observed at 4 ft bgs.	
								Bottom of test pit at 4 ft bgs.

\*\*Possible malfunctioning PID/FID meter.

**ADDITIONAL NOTES / SKETCHES**

Samples collected from the west and east excavation side walls.  
Water seeping into excavation at 2.8 ft bgs.

EXCAVATING CONTRACTOR	Wilder Construction
EXCAVATION METHOD	Backhoe - John Deere 310
SAMPLING EQUIPMENT	Stainless Steel Spoon/Shovel/Bowl
COORDINATES	Northing: 649033.38 ft Easting: 1235087.80 ft
SURFACE ELEVATION	30.16 ft
DATUMS	Horizontal: NAD 83/91 Vertical: NAVD 88

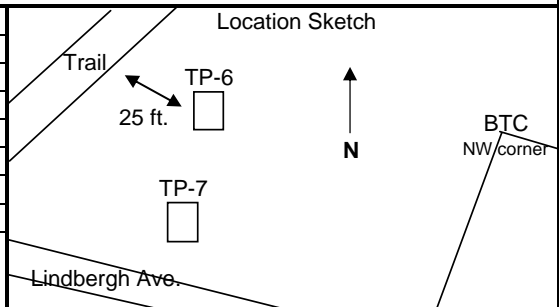



1201 Cornwall Avenue, Suite 208  
Bellingham, WA 98225

(360) 756-9296 FAX (360) 756-7914

TEST PIT NUMBER TP-7  
PROJECT Little Squalicum Park RI/FS  
LOCATION Bellingham, Washington  
PROJECT NUMBER C075-02  
LOGGED BY M. Herrenkohl, P.E.G.  
DATE November 8, 2005

SAMPLE INFORMATION					Depth (ft)	STRATA	DESCRIPTION
Sample ID	Sample Time	PID (ppm)	Sheen	Sample Depth (ft)			
LSP0040	1015	0	NS	0-1	SP/SM	Sand w/ silt/silty sand, 5YR 4/3, zones of fine grained material, some earthworms observed, moist, earthy odor (native?).	
LSP0041	1020	0	NS	1-2			
LSP0042	1025	0	NS	2-3	2--	SP ▼	F-M sand w/ gravel & silt, 7.5YR 4/4, scattered gravel, some lenses of silty sand. Saturated at 3' bgs, increased gravel content, decreased fines content.
LSP0043	1030	0	NS	3			
					4--		Bottom of test pit at 3' bgs.

**ADDITIONAL NOTES / SKETCHES**

Samples collected from the south and east excavation side walls.

EXCAVATING CONTRACTOR	Wilder Construction	
EXCAVATION METHOD	Backhoe - John Deere 310	
SAMPLING EQUIPMENT	Stainless Steel Spoon and Bowl	
COORDINATES	Northing: 648836.71 ft Easting: 1235050.25 ft	
SURFACE ELEVATION	28.71 ft	
DATUMS	Horizontal: NAD 83/91 Vertical: NAVD 88	



1201 Cornwall Avenue, Suite 208  
Bellingham, WA 98225

(360) 756-9296 FAX (360) 756-7914

TEST PIT NUMBER TP-8  
PROJECT Little Squalicum Park RI/FS  
LOCATION Bellingham, Washington  
PROJECT NUMBER C075-02  
LOGGED BY M. Herrenkohl, P.E.G.  
DATE November 8, 2005

SAMPLE INFORMATION					Depth (ft)	STRATA	DESCRIPTION
Sample ID	Sample Time	PID (ppm)	Sheen	Sample Depth (ft)			
LSP0037	0830	2	NS	0-1.4	2--	GM	Silty sandy gravel, brown (7.5 YR 4/3), 50% F-M gravel, 30% F-M sand, 20% fines (mostly silt), trace of clay, slight plasticity, poorly sorted.
LSP0038	0835	2	NS	1.4 - 3		SM	some earthworms observed, moist (fill). Silty F-M sand, dark brown to brown (7.5 YR 3.2 to 7.5 YR 4.3), no plasticity, 80% F-M sand, >20% fines (silty), scattered gravels, moist to wet (native).
LSP0039	0840	3	NS	3	4--	I	Color change at bottom of test pit (7.5 YR 6.1 - 6.2).  Bottom of test pit at 3 ft bgs.

**ADDITIONAL NOTES / SKETCHES**

Water seeping into excavation at 3 ft bgs.

EXCAVATING CONTRACTOR	Wilder Construction
EXCAVATION METHOD	Backhoe - John Deere 310
SAMPLING EQUIPMENT	Stainless Steel Spoon and Bowl
COORDINATES	Northing: 648819.66 ft Easting: 1234837.58 ft
SURFACE ELEVATION	26.95 ft
DATUMS	Horizontal: NAD 83/91 Vertical: NAVD 88

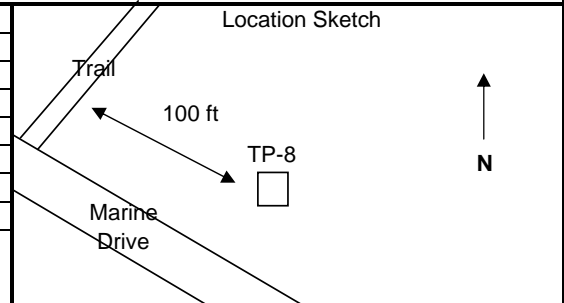



1201 Cornwall Avenue, Suite 208  
Bellingham, WA 98225

(360) 756-9296 FAX (360) 756-7914

TEST PIT NUMBER TP-9  
PROJECT Little Squalicum Park RI/FS  
LOCATION Bellingham, Washington  
PROJECT NUMBER C075-02  
LOGGED BY Eron Dodak, R.G.  
DATE November 7, 2005

SAMPLE INFORMATION						Depth (ft)	STRATA	DESCRIPTION
Sample ID	Sample Time	PID (ppm)	Sheen		Sample Depth (ft)			
LSP0031	1600	2	NS		0-1	SM/ML	Sand with silt and gravel/silt with sand and gravel, dark brown (7.5 YR 3/2), 20% F-C subrounded to rounded gravel, 40% silt, 40% fine sand, trace glass and some concrete, moist, no odor (fill).	
LSP0032	1605	2	LS		1-2			
LSP0033	1610	<1	NS		2-3	GW/SW	Gravel w/ sand/sand w/ gravel, dark brown (7.5 YR 3/2), 45% F-C subrounded to rounded gravel, 45% F-C sand, 10% silt, moist, no odor (fill to ~2.8 ft bgs).	
-	-	-	LS		3			
LSP0034	1615	1	NS		3-4	SP	Fine sand, v. dark brown (7.5 YR 2.5/2), 5-10% silt, wet, no odor.	
LSP0036	1620	1	NS		4			
Bottom of test pit at 4 ft bgs.								

**ADDITIONAL NOTES / SKETCHES**

Water seeping into excavation at 4 ft bgs.  
Samples collected from north and south excavation side walls.  
Concrete encountered at 2.8 ft bgs.

EXCAVATING CONTRACTOR	Wilder Construction
EXCAVATION METHOD	Backhoe - John Deere 310
SAMPLING EQUIPMENT	Stainless Steel Spoon and Bowl
COORDINATES	Northing: 648641.99 ft Easting: 1234552.91 ft
SURFACE ELEVATION	24.54 ft
DATUMS	Horizontal: NAD 83/91 Vertical: NAVD 88

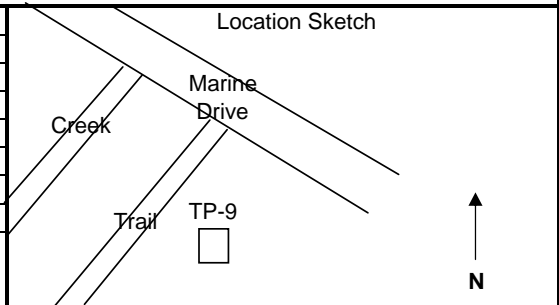



1201 Cornwall Avenue, Suite 208  
Bellingham, WA 98225

(360) 756-9296 FAX (360) 756-7914

TEST PIT NUMBER TP-10  
PROJECT Little Squalicum Park RI/FS  
LOCATION Bellingham, Washington  
PROJECT NUMBER C075-02  
LOGGED BY Eron Dodak, R.G.  
DATE November 7, 2005

SAMPLE INFORMATION						Depth (ft)	STRATA	DESCRIPTION
Sample ID	Sample Time	PID (ppm)	Sheen		Sample Depth (ft)			
LSP0028	1300	0	LS		0-1	GM	USCS group name, color, grain size range, minor constituents, plasticity, odor, sheen, moisture content, texture, weathering, cementation, geologic interpretation, etc.	
LSP0029	1305	0	LS		1-2		▼	Gravel with silt and sand, brown (7.5 YR 4/2), 25% fine sand, 20% silt, mostly subrounded to rounded fine gravel, weak odor (fill).
LSP0030	1310	<1	NS		2-3	2--	SP	As above w/color v. dark gray (7.5 YR 3/1), 35% sand, 10% silt (fill)
LSP0035	1315	0	NS		3-4		SM	Fine sand, v. dark gray (10 YR 3/1), 5-10% silt, some orange banding, moist to wet, no odor.
					4--			Sand with silt, v. dark grayish brown (10 YR 3/2), 20-25% silt, fine sand, slightly micaceous, v. moist to wet, no odor.
								Bottom of test pit at 4 ft bgs.

**ADDITIONAL NOTES / SKETCHES**

Sample was not collected at the bottom of excavation due to 2-3 inches of standing water. Unable to remove water with the backhoe bucket.  
Water seeping into excavation at 1 ft bgs.  
Steel pipe observed at 1.5 ft bgs, piece of milled wood observed at 2 ft bgs.  
Piece of treated wood debris with odor observed at 0.7 ft bgs.  
Samples collected from west, east, and south excavation side walls.

EXCAVATING CONTRACTOR	Wilder Construction	Location Sketch
EXCAVATION METHOD	Backhoe - John Deere 310	
SAMPLING EQUIPMENT	Stainless Steel Spoon and Bowl	
COORDINATES	Northing: 648455.94 ft Easting: 1234485.41 ft	
SURFACE ELEVATION	19.18 ft	
DATUMS	Horizontal: NAD 83/91 Vertical: NAVD 88	



1201 Cornwall Avenue, Suite 208  
Bellingham, WA 98225

(360) 756-9296 FAX (360) 756-7914

TEST PIT NUMBER TP-11  
PROJECT Little Squalicum Park RI/FS  
LOCATION Bellingham, Washington  
PROJECT NUMBER C075-02  
LOGGED BY Eron Dodak, R.G.  
DATE November 7, 2005

SAMPLE INFORMATION						Depth (ft)	STRATA	DESCRIPTION
Sample ID	Sample Time	PID (ppm)	Sheen	Sample Depth (ft)				
LSP0023	1115	<1	NS	0-1	2--	ML	Silt with sand, v. dark gray (7.5 YR 3/1) 20-25% fine sand, 5-10% fine to coarse gravel, 5-10% roots, moist, no odor.	
LSP0027	1140	0	NS	1.4-2		SM	Fine sand w/ silt, black (7.5 YR 2.5/1), micaceous, 15-20% silt, moist, no odor to slight sulfur odor. A small pocket of strong brown (7.5YR 5/6) gravel w/sand was observed from 1.4-2 ft bgs near the SE corner of the test pit (sample collected).	
LSP0024	1125	<1	NS	1-2	4--		As above with color dark brown (7.5 YR 3/2).	
LSP0026	1130	1	NS	2-3			Bottom of test pit at 3 ft bgs.	
LSP0025	1135	0	NS	3				

**ADDITIONAL NOTES / SKETCHES**

Water seeping into excavation at 2.6 ft bgs.  
Samples collected from north, south, and east excavation side walls.

EXCAVATING CONTRACTOR	Wilder Construction
EXCAVATION METHOD	Backhoe - John Deere 310
SAMPLING EQUIPMENT	Stainless Steel Spoon and Bowl
COORDINATES	Northing: 648454.98 ft Easting: 1234581.92 ft
SURFACE ELEVATION	20.66 ft
DATUMS	Horizontal: NAD 83/91 Vertical: NAVD 88

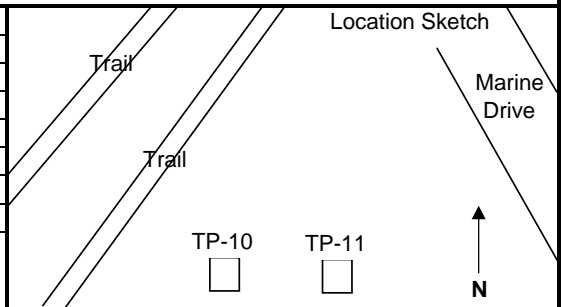



1201 Cornwall Avenue, Suite 208  
Bellingham, WA 98225

(360) 756-9296 FAX (360) 756-7914

TEST PIT NUMBER	TP-12
PROJECT	Little Squalicum Park RI/FS
LOCATION	Bellingham, Washington
PROJECT NUMBER	C075-02
LOGGED BY	Eron Dodak, R.G.
DATE	November 7, 2005

SAMPLE INFORMATION						Depth (ft)	STRATA	DESCRIPTION
Sample ID	Sample Time	PID (ppm)	Sheen		Sample Depth (ft)			
LSP0019	0920	0.7	No		0-1	2--	ML	Silt with sand, dark brown (7.5 YR 3/2) 15% F-M sand, 5% F-C gravel, 5-10% roots, moist, no odor.
LSP00020	0925	1	No		1-2		GM	Gravel w/silt & sand, dk. brn. (10 YR 3/2), 20-25% silt, 15% F-M sand, no odor.
LSP0021	0930	1.2	No		2-3		GW	Fine to coarse gravel with sand, brown (7.5 YR 4/2), 20-25% M-C sand, mostly fine subrounded to rounded gravel, v. moist to wet, no odor.
LSP0022	0935	1.8	No		3			Bottom of test pit at 3 ft bgs.
						4--		

**ADDITIONAL NOTES / SKETCHES**

Water seeping into excavation at 2.3 ft bgs.  
Samples collected from north, south, and east excavation side walls.

EXCAVATING CONTRACTOR	Wilder Construction
EXCAVATION METHOD	Backhoe - John Deere 310
SAMPLING EQUIPMENT	Stainless Steel Spoon and Bowl
COORDINATES	Northing: 648299.38 ft Easting: 1234434.29 ft
SURFACE ELEVATION	16.35 ft
DATUMS	Horizontal: NAD 83/91 Vertical: NAVD 88

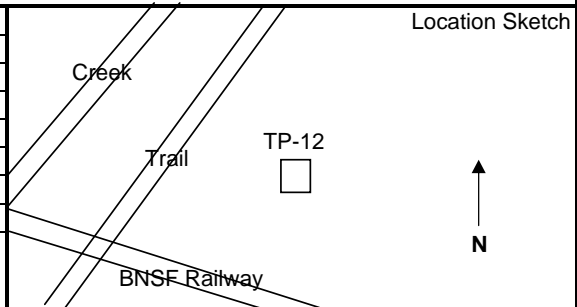



1201 Cornwall Avenue, Suite 208  
Bellingham, WA 98225

(360) 756-9296 FAX (360) 756-7914

TEST PIT NUMBER TP-13  
PROJECT Little Squalicum Park RI/FS  
LOCATION Bellingham, Washington  
PROJECT NUMBER C075-02  
LOGGED BY Susan Fitzgerald, P.G.  
DATE November 16, 2005

SAMPLE INFORMATION						Depth (ft)	STRATA	DESCRIPTION
Sample ID	Sample Time	PID/FID (ppm)	Sheen		Sample Depth (ft)			
LSP0083	0820	1.7/0	NS		0-1	GM	Silty gravel w/ sand, v. dark brown (10YR 2/2), 60% F-C subangular gravel, 20% F-C sand, 20% fines, gravel up to 2" dia., trace roots/rootlets, no odor.	
LSP0084	0825	0.7/0	NS		1-5.5			
						2--	SP/SM	Sand with silt, yellowish brown (10YR 5/4), F-C sand (trace C, 20% M, 80% F), 10% silt, gravelly to 2.8 ft, trace to no gravel below 2.8 ft, some orange mottling, trace of clasts of medium plasticity material, no odor.
						4--	▼	Wet at 3.8 ft bgs.
								Bottom of test pit at 5.5 ft bgs.

**ADDITIONAL NOTES / SKETCHES**

Samples collected from southeast excavation side wall.  
The 0-1 ft sample was collected directly from excavation side wall.  
The 1-5.5 ft composite sample was collected from the excavator bucket.  
  
Background PID = 0.2 ppm, FID=0.0 ppm

EXCAVATING CONTRACTOR	Wilder Construction
EXCAVATION METHOD	Backhoe - John Deere 310
SAMPLING EQUIPMENT	Stainless Steel Spoon and Bowl
COORDINATES	Northing: 649118.15 ft Easting: 1235099.31 ft
SURFACE ELEVATION	31.78 ft
DATUMS	Horizontal: NAD 83/91 Vertical: NAVD 88

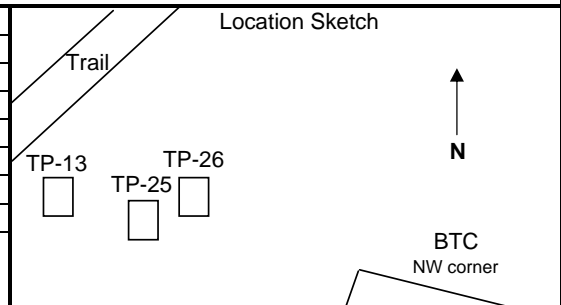



1201 Cornwall Avenue, Suite 208  
Bellingham, WA 98225

(360) 756-9296 FAX (360) 756-7914

TEST PIT NUMBER TP-14  
PROJECT Little Squalicum Park RI/FS  
LOCATION Bellingham, Washington  
PROJECT NUMBER C075-02  
LOGGED BY Susan Fitzgerald, P.G.  
DATE November 16, 2005

SAMPLE INFORMATION					Depth (ft)	STRATA	DESCRIPTION
Sample ID	Sample Time	PID/FID (ppm)	Sheen	Sample Depth (ft)			
LSP0085	0925	1.0/0	NS	0-0.5	2--	GM	Silty gravel with sand, some roots, rootlets, and worms, no odor.
LSP0086	0930	1.4/0	NS	0.5-4.2		SW/SP	F-C sand, dark yellowish brown (10YR 4/4), trace gravel, sand (10% C, 70% M, 20% F).
					4--	SP/SM	Sand w/ silt, light olive brown (2.5Y5/3), trace roots, orange mottling throughout, no odor.

ADDITIONAL NOTES / SKETCHES

The 0-0.5 ft sample was collected directly from excavation side wall.  
The 0.5-4.2 ft composite sample was collected from the excavator bucket.  
Background PID = 0.4 ppm, FID=0.0 ppm

EXCAVATING CONTRACTOR	Wilder Construction
EXCAVATION METHOD	Backhoe - John Deere 310
SAMPLING EQUIPMENT	Stainless Steel Spoon and Bowl
COORDINATES	Northing: 649095.94 ft Easting: 1235115.79
SURFACE ELEVATION	9
DATUMS	Horizontal: NAD 83/91 Vertical: NAVD 88

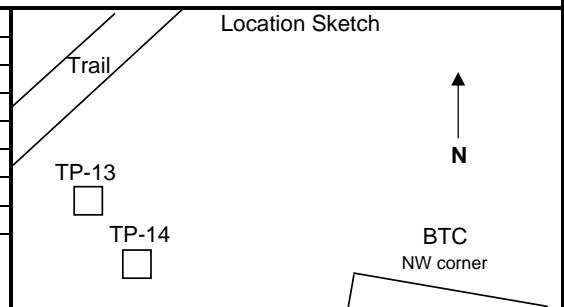



1201 Cornwall Avenue, Suite 208  
Bellingham, WA 98225

(360) 756-9296 FAX (360) 756-7914

TEST PIT NUMBER TP-15  
PROJECT Little Squalicum Park RI/FS  
LOCATION Bellingham, Washington  
PROJECT NUMBER C075-02  
LOGGED BY Susan Fitzgerald, P.G.  
DATE November 16, 2005

SAMPLE INFORMATION						Depth (ft)	STRATA	DESCRIPTION
Sample ID	Sample Time	PID/FID (ppm)	Sheen	Sample Depth (ft)				
LSP0078	1110	1.6/0	LS	0-1	2-- 4--	SC	Clayey sand with gravel, v. dark brown (10YR 2/2), 20% gravel, 60% sand, 20% fines (med. plasticity), faint odor in gravel lenses, some organics, moist.	
LSP0079	1105	2.0/0	NS	1-2		SW/SM	Sand with silt, v. dark brown, 10% gravel, 75% fine to coarse sand, 10-15% silt, angular to subrounded gravel up to 3" dia., moist, no odor.	
LSP0080	1100	1.7/0	NS	2-3		ML/CL	Sandy silt/clay, 10% gravel, 20% F sand, 70% fines, med plasticity, subrounded gravels up to 1" dia., some black organic lenses 3-4" thick, moist, no odor.	
LSP0081	1120	2.2/0	LS	3-4		SM	Silty sand with gravel, v. dark gray (10YR 3/1), 30% F-C gravel, 50% F-C sand, 20% fines, subangular to subrounded gravels up to 4" dia., mild "sweet odor".	
Bottom of test pit at 4 ft bgs.								

**ADDITIONAL NOTES / SKETCHES**

Cobbles up to 10 in. long removed from test pit.  
The 0-1 ft, 1-2 ft, 2-3 ft samples collected directly from west excavation side wall.  
The 3-4 ft sample collected and described from excavator bucket.  
  
Background PID = 0.4-0.3 ppm.

EXCAVATING CONTRACTOR	Wilder Construction
EXCAVATION METHOD	Backhoe - John Deere 310
SAMPLING EQUIPMENT	Stainless Steel Spoon and Bowl
COORDINATES	Northing: 649050.98 ft Easting: 1235148.03 ft
SURFACE ELEVATION	31.20 ft
DATUMS	Horizontal: NAD 83/91 Vertical: NAVD 88

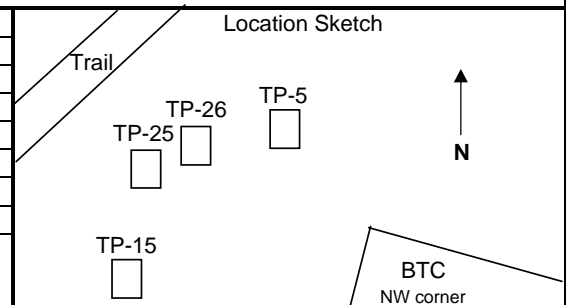



1201 Cornwall Avenue, Suite 208  
Bellingham, WA 98225

(360) 756-9296 FAX (360) 756-7914

TEST PIT NUMBER TP-16  
PROJECT Little Squalicum Park RI/FS  
LOCATION Bellingham, Washington  
PROJECT NUMBER C075-02  
LOGGED BY Susan Fitzgerald, P.G.  
DATE November 16, 2005

SAMPLE INFORMATION						Depth (ft)	STRATA	DESCRIPTION
Sample ID	Sample Time	PID/FID (ppm)	Sheen	Sample Depth (ft)				
LSP0088	1345	1.4/0	NS	0-2	2--	SP/SM	Sand with silt, brown (10YR 4/3), poorly graded, 10% gravel, 80% sand, 10% silt, some roots (mostly in top 0.5 ft bgs), moist. Subrounded cobbles up to 4" dia. near GP/GM contact.	
LSP0087	1355	1.6/0	NS	2-4		GP/GM	Gravel with silt, v. dk brn (10YR 2/2), poorly graded, 5-10% silt, 20% F sand, no odor. Discontinuous dense black organic layer at 2 ft bgs, no odor.	
					4--	SM/ML	Silty fine sand, brown (10YR 4/3), trace gravel, 25% silt, 75% sand, some clayey lenses, mottling (estimated 10%), no odor.	
								Bottom of excavation at 4 ft bgs.

**ADDITIONAL NOTES / SKETCHES**

The 0-2 ft sample was collected directly from the northwest excavation side wall.  
The 2-4 ft sample was collected from the excavator bucket.  
Water seeping into excavation at 3.5 ft bgs.

EXCAVATING CONTRACTOR	Wilder Construction
EXCAVATION METHOD	Backhoe - John Deere 310
SAMPLING EQUIPMENT	Stainless Steel Spoon and Bowl
COORDINATES	Northing: 648944.72 ft Easting: 1235185.97 ft
SURFACE ELEVATION	29.00 ft
DATUMS	Horizontal: NAD 83/91 Vertical: NAVD 88

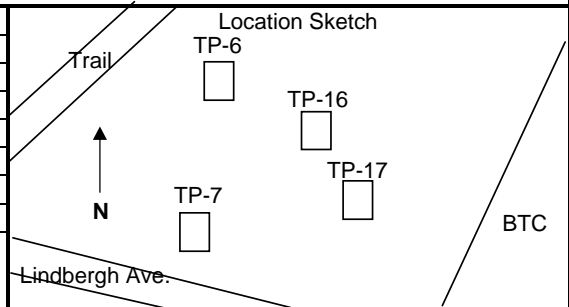



1201 Cornwall Avenue, Suite 208  
Bellingham, WA 98225

(360) 756-9296 FAX (360) 756-7914

TEST PIT NUMBER TP-17  
PROJECT Little Squalicum Park RI/FS  
LOCATION Bellingham, Washington  
PROJECT NUMBER C075-02  
LOGGED BY Susan Fitzgerald, P.G.  
DATE November 16, 2005

SAMPLE INFORMATION					Depth (ft)	STRATA	DESCRIPTION
Sample ID	Sample Time	PID/FID (ppm)	Sheen	Sample Depth (ft)			
LSP0089	1510	1.1/0	NS	0-1	2-4	ML	Sandy silt, brown (10YR4/3), trace gravel, 35% fine sand, 65% silt, sulfur odor, damp, soft.
LSP0090	1515	2.4/0	NS	1-2		SM	Silty sand, dark grayish brown (10 YR 4/2), 80% sand (v. fine to fine), 20% silt, soft, damp.
LSP0091	1520	2.2/0	NS	2-3			As above with 70% sand, 30% silt, trace coarse sand, some rootlets, no odor.
LSP0092	1525	2/0	NS	3-4		ML/SM	Silt with sand (dark gray, 10YR 4/1) and silt (v. dark gray, 10YR 3/1), heterogeneous mixture, v. fine to fine sand, mottled, no odor.
					4-		Bottom of test pit at 4 ft bgs.

**ADDITIONAL NOTES / SKETCHES**

The 0-1 and 1-2 ft samples were collected directly from the north excavation side wall.  
The 2-3 and 3-4 ft samples were collected from the excavator bucket.  
Water seeping into excavation at 2 ft bgs.  
Background PID = 0.4 ppm.  
Gray clay present at 4 ft based on excavation spoils.  
Water seeping into excavation rapidly at 2 ft bgs.

EXCAVATING CONTRACTOR	Wilder Construction
EXCAVATION METHOD	Backhoe - John Deere 310
SAMPLING EQUIPMENT	Stainless Steel Spoon and Bowl
COORDINATES	Northing: 648860.83 ft Easting: 1235211.84 ft 27.73 ft
SURFACE ELEVATION	Horizontal: NAD 83/91
DATUMS	Vertical: NAVD 88

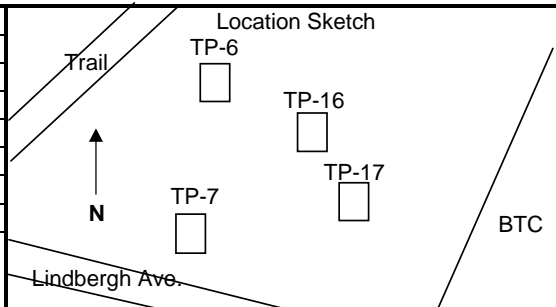



1201 Cornwall Avenue, Suite 208  
Bellingham, WA 98225

(360) 756-9296 FAX (360) 756-7914

TEST PIT NUMBER TP-18  
PROJECT Little Squalicum Park RI/FS  
LOCATION Bellingham, Washington  
PROJECT NUMBER C075-02  
LOGGED BY Susan Fitzgerald, P.G.  
DATE November 17, 2005

SAMPLE INFORMATION					Depth (ft)	STRATA	DESCRIPTION
Sample ID	Sample Time	PID/FID (ppm)	Sheen	Sample Depth (ft)			
LSP0093	0815	0.2/0	NS	0-1	2--	GW/GM	USCS group name, color, grain size range, minor constituents, plasticity, odor, sheen, moisture content, texture, weathering, cementation, geologic interpretation, etc.
LSP0094	0820	0/0.7	NS	1-2.5			Gravel with silt and sand, v. dark grayish brown (10YR 3/2), 60% gravel ~2" dia., 25% F-C sand, 10% silt, some roots and earthworms observed, moist, no odor
LSP0095	0825	0.1/0	NS	2.5-3.5			As above but hard to v. hard, trace roots, yellowish brown (10YR 5/4). As above with color grayish brown (10YR 5/2), 70% F-C gravel with cobbles, 20% F-C sand, 10% silt, some rust colored mottling.
					4--	SW/SM	Sand with silt, v. dark grayish brown (2.5Y 3/2), well graded sand (F-C), 10% silt loose, moist, no odor.
							Bottom of test pit at 3.5 ft bgs.

**ADDITIONAL NOTES / SKETCHES**

All samples collected from northeast corner and east excavation side wall.

Background PID and FID = 0.0 ppm.

EXCAVATING CONTRACTOR	Wilder Construction
EXCAVATION METHOD	Backhoe - John Deere 310
SAMPLING EQUIPMENT	Stainless Steel Spoon and Bowl
COORDINATES	Northing: 648782.44 ft Easting: 1235141.76 ft
SURFACE ELEVATION	27.08 ft
DATUMS	Horizontal: NAD 83/91 Vertical: NAVD 88

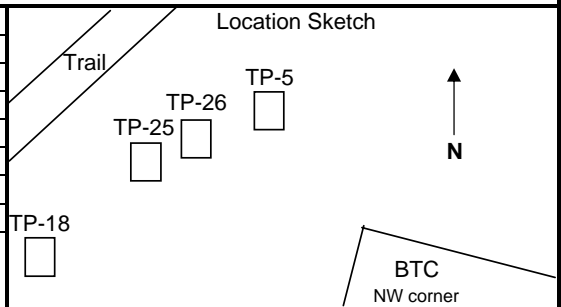



1201 Cornwall Avenue, Suite 208  
Bellingham, WA 98225

(360) 756-9296 FAX (360) 756-7914

TEST PIT NUMBER TP-19  
PROJECT Little Squalicum Park RI/FS  
LOCATION Bellingham, Washington  
PROJECT NUMBER C075-02  
LOGGED BY Susan Fitzgerald, P.G.  
DATE November 17, 2005

SAMPLE INFORMATION						Depth (ft)	STRATA	DESCRIPTION
Sample ID	Sample Time	PID (ppm)	Sheen		Sample Depth (ft)			
LSP0096	1000	0.3	NS		0-1	2--	GW/GM	Gravel with silt and sand, v. dark brown (10YR 2/2), 50% gravel, 40% sand, 10% fines, some roots, one earthworm observed, damp, no odor.
LSP0097	1005	0.2	NS		1-2		GW	As above with color dark yellow brown (10 YR 5/4), 70% gravel, 20% sand, 5-10% silt, firm to hard, damp, no odor
LSP0098	1010	0.4	NS		2-3		SP	Sand poorly graded, light olive brn (2.5Y 5/3), F-M sand, hard, damp, no odor. As above with color yellowish brown (10YR 4/6), 10% silt, trace black organic lenses and clay lenses.
						4--		Bottom of test pit at 3 ft bgs.

**ADDITIONAL NOTES / SKETCHES**

Background PID = 0.0 ppm. FID meter malfunctioning.

EXCAVATING CONTRACTOR	Wilder Construction
EXCAVATION METHOD	Backhoe - John Deere 310
SAMPLING EQUIPMENT	Stainless Steel Spoon and Bowl
COORDINATES	Northing: 648992.97 ft Easting: 1235072.11 ft
SURFACE ELEVATION	29.97 ft
DATUMS	Horizontal: NAD 83/91 Vertical: NAVD 88

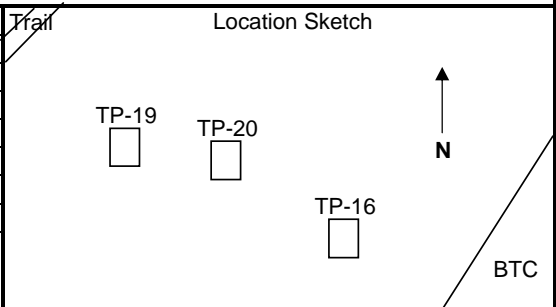



1201 Cornwall Avenue, Suite 208  
Bellingham, WA 98225

(360) 756-9296 FAX (360) 756-7914

TEST PIT NUMBER TP-20  
PROJECT Little Squaticum Park RI/FS  
LOCATION Bellingham, Washington  
PROJECT NUMBER C075-02  
LOGGED BY Susan Fitzgerald, P.G.  
DATE November 17, 2005

SAMPLE INFORMATION						Depth (ft)	STRATA	DESCRIPTION <small>USCS group name, color, grain size range, minor constituents, plasticity, odor, sheen, moisture content, texture, weathering, cementation, geologic interpretation, etc.</small>
Sample ID	Sample Time	PID/FID	Sheen		Sample Depth (ft)			
LSP0099	1130	0.4/0	NS		0-2	2--	GW/GM	Gravel with silt and sand, v. dark grayish brown (10YR 3/2), 50% F-C gravel, 40% VF-M sand with trace coarse, 10% silt, no odor. Loose/loamy with organic detritus (20%) from surface to 0.5' bgs.
LSP0101	1235	-	NS		1.3-2		PT	Humic peat: black (2.5Y 2.5/1), thickness varies around test pit, hard, moist.
LSP0100	1130	0.5/0	NS		2-4		GM	Silty gravel with sand, dark yellowish brown (10YR 4/6), 60% subrounded to subangular F-C gravel (up to 2" dia.), 25% VF-M sand, 15% silt, firm, no odor.
						4--	▼	Bottom of test pit at 4 ft bgs.

**ADDITIONAL NOTES / SKETCHES**

Water seeping into excavation at 4 ft bgs.  
Samples collected from northwest corner of excavation side wall.  
Background PID = 0.0 ppm.

EXCAVATING CONTRACTOR	Wilder Construction
EXCAVATION METHOD	Backhoe - John Deere 310
SAMPLING EQUIPMENT	Stainless Steel Spoon and Bowl
COORDINATES	Northing: 648982.56 ft Easting: 1235130.08
SURFACE ELEVATION	30.87 ft
DATUMS	Horizontal: NAD 83/91 Vertical: NAVD 88

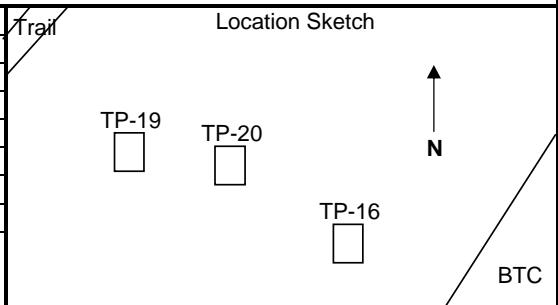



1201 Cornwall Avenue, Suite 208  
Bellingham, WA 98225

(360) 756-9296 FAX (360) 756-7914

TEST PIT NUMBER TP-21  
PROJECT Little Squalicum Park RI/FS  
LOCATION Bellingham, Washington  
PROJECT NUMBER C075-02  
LOGGED BY Susan Fitzgerald, P.G.  
DATE November 17, 2005

SAMPLE INFORMATION						Depth (ft)	STRATA	DESCRIPTION
Sample ID	Sample Time	PID/FID (ppm)	Sheen	Sample Depth (ft)				
LSP0102	1310	0.1/0	NS	0-2	2--	GW/GM	Gravel w/ silt & sand, dk yellowish brown (10YR 3/4), 70% F-C gravel (up to 3.4" dia.), 20% F-C sand, 10% silt, some roots & earthworms observed, moist, no odor.	
						ML	Sandy silt with gravel, dark grayish brown (10YR 4/2), 10% gravel, 40% VF-F sand, 50% silt, trace rootlets, alternating clay/silt and gravel mixtures, trace black organic lenses, moist, no odor.	
LSP0103	1315	0.3/0	NS	2-4	4--	CL	Clay, v. dark gray (10YR 3/1), trace reddish mottling and dark organic lenses, firm to hard, few organics, moist, no odor.	
LSP0104*	1320			2-4				Bottom of test pit at 4 ft bgs.
*Duplicate								

**ADDITIONAL NOTES / SKETCHES**

All samples collected from east excavation side wall.

EXCAVATING CONTRACTOR	Wilder Construction	Location Sketch
EXCAVATION METHOD	Backhoe - John Deere 310	
SAMPLING EQUIPMENT	Stainless Steel Spoon and Bowl	
COORDINATES	Northing: 649085.54 ft Easting: 1235062.19 ft	
SURFACE ELEVATION	30.80 ft	
DATUMS	Horizontal: NAD 83/91	
	Vertical: NAVD 88	



1201 Cornwall Avenue, Suite 208  
Bellingham, WA 98225

(360) 756-9296 FAX (360) 756-7914

TEST PIT NUMBER TP-22  
PROJECT Little Squalicum Park RI/FS  
LOCATION Bellingham, Washington  
PROJECT NUMBER C075-02  
LOGGED BY Eron Dodak, R.G.  
DATE January 31, 2006

SAMPLE INFORMATION					Depth (ft)	STRATA	DESCRIPTION
Sample ID	Time	PID/FID	Sheen	Sample Depth			
LSP0105	0950	5.8/0	NS	0-0.5	2--	GW	Sandy gravel w/ silt, dark brown (7.5 YR 3/2), fine to 3" dia. gravel (40%), sand (30%), silt (30%), no garbage, moist, no odor (fill).
(1015 for VOC sample)						SM/ML	Silty sand/sandy silt w/gravel, v. dark gray (7.5 YR 3/1), 15% bottles/metal,
LSP0106	0940	6.0/0	NS	0.5-1.7		GW	10% charcoal, 30% silt, 30% sand, 15% gravel, moist, no odor (fill).
LSP0107	0930	10.2/0	NS	1.7-2.2	4--	GW	Gravel w/ sand, reddish brown (5 YR 4/4), 15% bottles/glass, 30% sand, 55% gravel, moist to wet, no odor (fill).
(1040 for VOC sample)							
							Bottom of test pit at 4.5' bgs. Sampled to 2.2' bgs.

**ADDITIONAL NOTES / SKETCHES**

Water seeping into excavation at 2.2 ft bgs.  
Glass pieces, intact bottles, metal debris encountered from 0.5' to 4.5' bgs (bottom of test pit).  
A total of 31 intact bottles were removed from test pit (13 were collected for identification).

EXCAVATING CONTRACTOR	Wilder Construction
EXCAVATION METHOD	Track Hoe
SAMPLING EQUIPMENT	SS Spoons/bowls
COORDINATES	Northing: 648990.85 ft Easting: 1235612.97 ft
SURFACE ELEVATION	38.70 ft
DATUMS	Horizontal: NAD 83/91 Vertical: NAVD 88

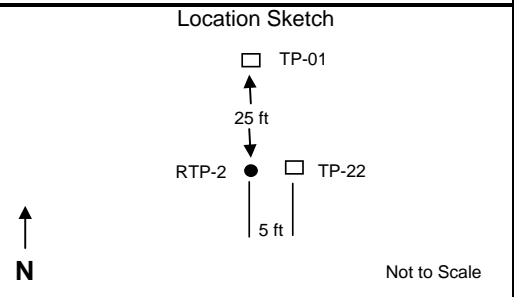



1201 Cornwall Avenue, Suite 208  
 Bellingham, WA 98225  
 (360) 756-9296 FAX (360) 756-7914

TEST PIT NUMBER TP-23  
 PROJECT Little Squalicum Park RI/FS  
 LOCATION Bellingham, Washington  
 PROJECT NUMBER C075-02  
 LOGGED BY Eron Dodak, R.G.  
 DATE January 31, 2006

SAMPLE INFORMATION					Depth (ft)	STRATA	DESCRIPTION	
Sample ID	Time	PID/FID	Sheen	Sample Depth				
LSP0108	1210	2.6	NS	0-2.0	2--	ML	Sandy Silt w/ gravel, brown (10 YR 4/2), ~15% sand, 25% fine to 8" dia. gravel, ~60% silt, moist, no odor, no garbage observed (fill).	
LSP0104	1155	2.4	NS	2.0-3.5			Sandy silt w/ gravel, very dark gray brown (10 YR 3/2), ~15% debris (glass, bottles, metal), ~25% sand, ~25% fine to 3" gravel, ~35% silt, moist, no odor (fill).	
LSP0110	1145	3	NS	3.5 - 4.0	4--	GW	~30% debris (glass, metal), v. moist, no odor (fill).	
LSP0111	1140	3.2	NS	4.0		ML	Organic-rich silt w/ gravel, black (5 YR 2.5/1), slight sulfur odor, moist (native).	
LSP0112	1310	6.0	NS	4.5-5.0		SW	Sand w/ gravel, dark gray (7.5 YR 4/1), 15-25% F-C gravel, trace silt, v. moist to wet, no odor (native).	
							—	Bottom of test pit at 5.2 ft bgs.

**ADDITIONAL NOTES / SKETCHES**

Metal and glass debris observed from 2.5 ft to 4 ft bgs.  
 Water seeping into excavation at 5.2 ft bgs.  
 A total of 16 intact bottles were removed from test pit (13 were collected for identification).  
 No diesel odor observed (diesel odor was observed in RTP-18).

EXCAVATING CONTRACTOR	Wilder Construction
EXCAVATION METHOD	Track Hoe
SAMPLING EQUIPMENT	SS Spoons/bowls
COORDINATES	Northing: 648928.50 ft Easting: 1235685.09 ft
SURFACE ELEVATION	40.59 ft
DATUMS	Horizontal: NAD 83/91 Vertical: NAVD 88

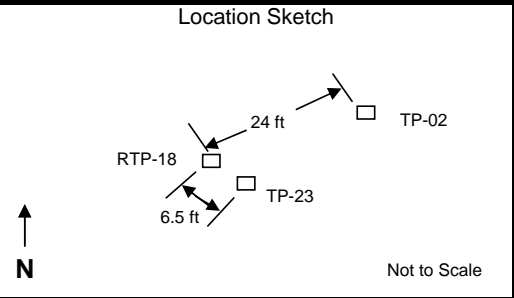



1201 Cornwall Avenue, Suite 208  
 Bellingham, WA 98225  
 (360) 756-9296 FAX (360) 756-7914

TEST PIT NUMBER	TP-24
PROJECT	Little Squalicum Park RI/FS
LOCATION	Bellingham, Washington
PROJECT NUMBER	C075-02
LOGGED BY	Eron Dodak, R.G.
DATE	January 31, 2006

SAMPLE INFORMATION					Depth (ft)	STRATA	DESCRIPTION
Sample ID	Time	PID/FID	Sheen	Sample Depth			
LSP0113	1410	4.8/0	NS	0-1.5	2--	ML	Silt with gravel, dark brown (7.5 YR 3/2), ~15% fine to coarse gravel, ~5-10% sand, trace roots, moist, no odor (fill?). No debris/garbage encountered.
LSP0114	1415	5.8/0	NS	1.5		GW	Gravel w/ sand, gray (10 YR 5/1), 35% sand, 5-10% silt, fine to 4" dia gravel, wet, no odor (native). No debris/garbage encountered.
					4--		Bottom of test pit at 3.2 ft bgs.

**ADDITIONAL NOTES / SKETCHES**

Standing water in test pit at 1.5 ft bgs.  
 Excavated to 3.2 ft bgs; could not excavate deeper due to sluffing gravel.

EXCAVATING CONTRACTOR	Wilder Construction
EXCAVATION METHOD	Track Hoe
SAMPLING EQUIPMENT	SS Spoons/bowls
COORDINATES	Northing: 649061.59 ft Easting: 1235609.45 ft
SURFACE ELEVATION	38.00 ft
DATUMS	Horizontal: NAD 83/91 Vertical: NAVD 88

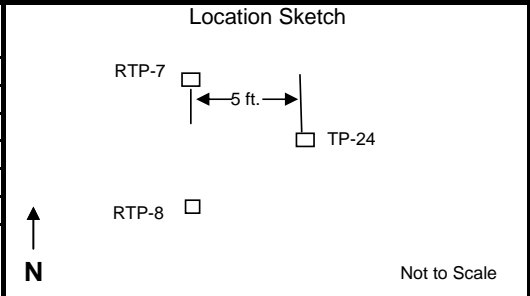



1201 Cornwall Avenue, Suite 208  
 Bellingham, WA 98225  
 (360) 756-9296 FAX (360) 756-7914

TEST PIT NUMBER TP-25  
 PROJECT Little Squalicum Park RI/FS  
 LOCATION Bellingham, Washington  
 PROJECT NUMBER C075-02  
 LOGGED BY Eron Dodak, R.G.  
 DATE February 1, 2006

SAMPLE INFORMATION					Depth (ft)	STRATA	DESCRIPTION
Sample ID	Time	PID/FID	Sheen	Sample Depth			
LSP0115	840	7.7/ 1.8	NS	0-0.6	2--	ML	Sandy silt, v. dark brown (10 YR 2/2), 30% fine to med. sand, abundant roots, v. moist, no odor.
LSP0116	835	7.0/ 1.9	NS	0.6-2.0		SP	Fine to med. Sand, dark yellowish-brown (10 YR 4/4), trace (~5%) silt, moist no odor.
LSP0117	825	8.1/ 7.8	NS	2.0-3.0	4--	▼	Wet at 2.5 ft bgs.
LSP0118	820	8.4/ 1.8	NS	3.0-4.0		—	Bottom of test pit at 4.0 ft bgs.

**ADDITIONAL NOTES / SKETCHES**

Water seeping into excavation at 2.5 ft bgs (standing water at 2.5 ft bgs).  
 After collecting the 2-3' and 3-4' bgs samples, the excavation was backfilled to ~2' bgs to safely collect the 0 - 0.6' and 0.6 - 2.0' bgs samples.  
 VOC sample was not collected from the 2-3' bgs interval due to standing water in the excavation.

EXCAVATING CONTRACTOR Wilder Construction  
 EXCAVATION METHOD Track Hoe  
 SAMPLING EQUIPMENT SS Spoons/bowls  
 COORDINATES Northing: 649108.43 ft  
Easting: 1235153.96 ft  
 SURFACE ELEVATION 32.57 ft  
 DATUMS Horizontal: NAD 83/91  
Vertical: NAVD 88

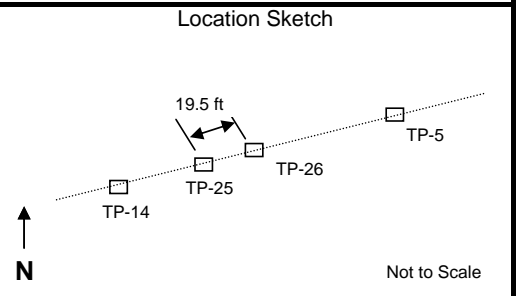



1201 Cornwall Avenue, Suite 208  
 Bellingham, WA 98225  
 (360) 756-9296 FAX (360) 756-7914

TEST PIT NUMBER TP-26  
 PROJECT W. Illinois Street Extension  
 LOCATION Bellingham, Washington  
 PROJECT NUMBER C317.0102  
 LOGGED BY Eron Dodak, R.G.  
 DATE October 12, 2006

SAMPLE INFORMATION					Depth (ft)	STRATA	DESCRIPTION
Sample ID	PID (ppm)	Sheen	Sample Time	Sample Depth			
LSP0649	3.7	NS	1555	0-1	2--	ML	USCS group name, color, grain size range, minor constituents, plasticity, odor, sheen, moisture content, texture, weathering, cementation, geologic interpretation, etc.
LSP0650	7.2	NS	1600	1-2		ML	Gravelly silt, dk brown (7.5YR 3/2), 20-25% F-2" dia. gravel, trace bituminous coal, 10%, M-C sand, some roots, one RR spike, moist, no odor (fill).
LSP0651	8.6	NS	1605	2-3		Slightly clayey silt, grayish brown (10YR 5/2) some orange mottling, moderately stiff, few roots, moist, no odor (native).	
LSP0652	7.9	NS	1610	3-4		as above with no roots.	
Background PID=0.0ppm					4--	—	Test pit terminated at 4 ft bgs
							No evidence of contamination observed

ADDITIONAL NOTES / SKETCHES

0-3' samples collected from test pit sidewalls  
 3-4' sample collected from track hoe bucket

EXCAVATING CONTRACTOR	Wilder Construction
EXCAVATION METHOD	Track Hoe
SAMPLING EQUIPMENT	Stainless steel bowl, spoon
COORDINATES	Northings: 649449.122 Eastings: 1234694.701
SURFACE ELEVATION	
DATUM	Horizontal: NAD 83/91

Location Sketch

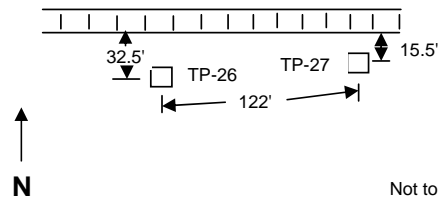

Not to Scale



1201 Cornwall Avenue, Suite 208  
 Bellingham, WA 98225  
 (360) 756-9296 FAX (360) 756-7914

TEST PIT NUMBER TP-27  
 PROJECT W. Illinois Street Extension  
 LOCATION Bellingham, Washington  
 PROJECT NUMBER C317.0102  
 LOGGED BY Eron Dodak, R.G.  
 DATE October 12, 2006

SAMPLE INFORMATION					Depth (ft)	STRATA	DESCRIPTION
Sample ID	PID (ppm)	Sheen	Sample Time	Sample Depth			
LSP0653	5.1	NS	1445	0-1	2--	GM/ML	Silty gravel/gravelly silt, dk grayish brown (10YR 4/2), 45% silt, 45% F-2" dia. gravel, 10% M-C sand, few pieces of wood, trace charcoal, moist, no odor (fill).
LSP0654	3.3	NS	1450	1-2		ML	Slightly clayey silt, brown (10YR 5/3) some orange mottling, trace black organics, slightly moist, no odor (native).
LSP0655	1.4	NS	1455	2-3			
LSP0656	4.7	NS	1500	3-4			as above with no black organics.
Background PID=0.0ppm					4--		Test pit terminated at 4 ft bgs
							No evidence of contamination observed

**ADDITIONAL NOTES / SKETCHES**

0-3' samples collected from test pit sidewalls  
 3-4' sample collected from track hoe bucket

EXCAVATING CONTRACTOR	Wilder Construction
EXCAVATION METHOD	Track Hoe
SAMPLING EQUIPMENT	Stainless steel bowl, spoon
COORDINATES	Northings: 649464.725 Eastings: 1234815.659
SURFACE ELEVATION	
DATUM	Horizontal: NAD 83/91

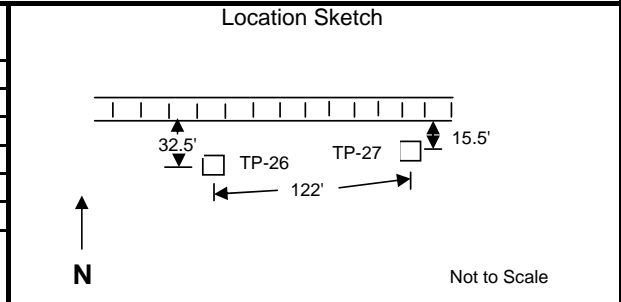



1201 Cornwall Avenue, Suite 208  
 Bellingham, WA 98225  
 (360) 756-9296 FAX (360) 756-7914

TEST PIT NUMBER TP-28  
 PROJECT W. Illinois Street Extension  
 LOCATION Bellingham, Washington  
 PROJECT NUMBER C317.0102  
 LOGGED BY Eron Dodak, R.G.  
 DATE October 12, 2006

SAMPLE INFORMATION					Depth (ft)	STRATA	DESCRIPTION
Sample ID	PID (ppm)	Sheen	Sample Time	Sample Depth			
LSP0657	1.5	NS	1335	0-1	2--	ML	USCS group name, color, grain size range, minor constituents, plasticity, odor, sheen, moisture content, texture, weathering, cementation, geologic interpretation, etc.
LSP0658	5.6	NS	1340	1-2		ML	Gravelly silt, dk grayish brown (10YR 4/2), 30% F-3" dia gravel, 10% M-C sand, 5-10% bituminous coal 0.9-1.2' bgs, moist, no odor (fill).
LSP0659	9.4	NS	1345	2-3		Slightly clayey silt, brown (10YR 5/3), trace roots and organics, some orange mottling, moderately stiff, moist, no odor (native).	
LSP0660	8.4	NS	1350	3-4		as above, with color brown (10YR 4/3), no roots or organics.	
Background PID=0.0ppm					4--	—	Test pit terminated at 4 ft bgs
							No evidence of contamination observed

ADDITIONAL NOTES / SKETCHES

0-3' samples collected from test pit sidewalls  
 3-4' sample collected from track hoe bucket

EXCAVATING CONTRACTOR	Wilder Construction
EXCAVATION METHOD	Track Hoe
SAMPLING EQUIPMENT	Stainless steel bowl, spoon
COORDINATES	Northings: 649443.763 Eastings: 1234939.841
SURFACE ELEVATION	
DATUM	Horizontal: NAD 83/91

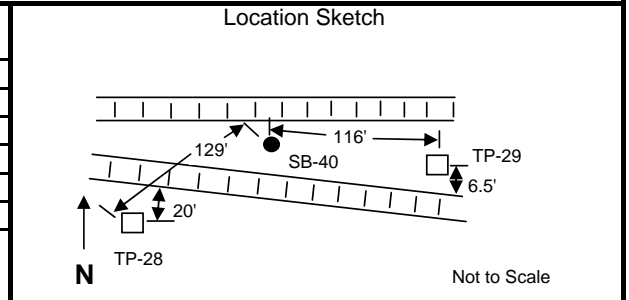



1201 Cornwall Avenue, Suite 208  
Bellingham, WA 98225

(360) 756-9296 FAX (360) 756-7914

TEST PIT NUMBER TP-29  
PROJECT W. Illinois Street Extension  
LOCATION Bellingham, Washington  
PROJECT NUMBER C317.0102  
LOGGED BY Eron Dodak, R.G.  
DATE October 12, 2006

SAMPLE INFORMATION					Depth (ft)	STRATA	DESCRIPTION
Sample ID	PID (ppm)	Sheen	Sample Time	Sample Depth			
LSP0661	2.4	NS	1125	0-1	2--	ML	Gravelly silt, brown (7.5YR 4/2), 30-35% F-4" dia. gravel, trace orange mottling, piece of bituminous coal at 1' bgs, moist, no odor (fill).
LSP0662	2.5	NS	1130	1-2			
LSP0663	3.4	NS	1135	2-3	4--	ML	Slightly clayey silt, grayish brown (10YR 5/2), v. stiff, slightly moist, no odor (native). as above with color brown (10YR 4/3), trace orange mottling.
LSP0664	2.8	NS	1140	3-4			
Background PID=0.0ppm							Test pit terminated at 4 ft bgs
							No evidence of contamination observed

ADDITIONAL NOTES / SKETCHES

0-3' samples collected from test pit sidewalls  
3-4' sample collected from track hoe bucket

EXCAVATING CONTRACTOR	Wilder Construction
EXCAVATION METHOD	Track Hoe
SAMPLING EQUIPMENT	Stainless steel bowl, spoon
COORDINATES	Northings: 649462.989 Eastings: 1235173.455
SURFACE ELEVATION	
DATUM	Horizontal: NAD 83/91

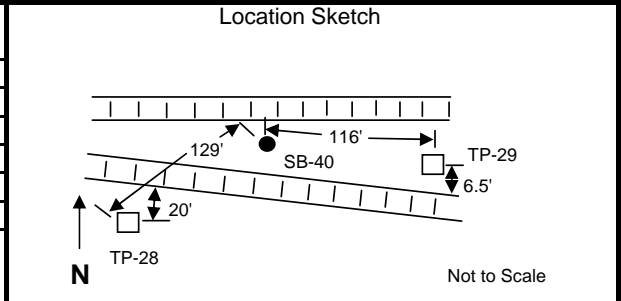



1201 Cornwall Avenue, Suite 208  
 Bellingham, WA 98225  
 (360) 756-9296 FAX (360) 756-7914

TEST PIT NUMBER TP-30  
 PROJECT W. Illinois Street Extension  
 LOCATION Bellingham, Washington  
 PROJECT NUMBER C317.0102  
 LOGGED BY Eron Dodak, R.G.  
 DATE October 12, 2006

SAMPLE INFORMATION					Depth (ft)	STRATA	DESCRIPTION	
Sample ID	PID (ppm)	Sheen	Sample Time	Sample Depth				
LSP0665	1.9	NS	1000	0-1	2--	ML	Silty gravel, v. dk grayish brown (10YR 3/2), 30% silt, 10% F-C sand, F-1.5" dia. gravel, trace roots/cattails, indistinct odor, moist (fill).	
LSP0673 (Dup)	"	"	1005	"		ML	Slightly clayey silt, brown (10YR 5/3), some orange mottling, trace roots and carbonized organics, trace F-3" dia. gravel, slightly moist, no odor (native).	
LSP0666	3.2	NS	1010	1-2				
LSP0667	3.6	NS	1015	2-3				
LSP0668	4.7	NS	1020	3-4				as above with no gravel or roots
					4--		Test pit terminated at 4 ft bgs	
Background PID=0.3ppm								

ADDITIONAL NOTES / SKETCHES

0-3' samples collected from test pit sidewalls  
 3-4' sample collected from track hoe bucket

EXCAVATING CONTRACTOR  
 EXCAVATION METHOD  
 SAMPLING EQUIPMENT  
 COORDINATES

Wilder Construction  
 Track Hoe  
 Stainless steel bowl, spoon  
 Northings: 649455.066  
 Eastings: 1235257.714

SURFACE ELEVATION  
 DATUM

Horizontal: NAD 83/91

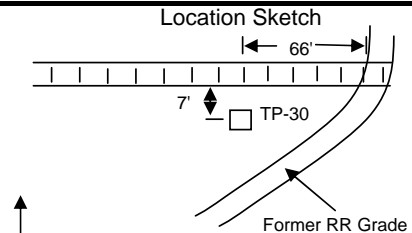

Not to Scale



1201 Cornwall Avenue, Suite 208  
 Bellingham, WA 98225  
 (360) 756-9296 FAX (360) 756-7914

TEST PIT NUMBER TP-31  
 PROJECT W. Illinois Street Extension  
 LOCATION Bellingham, Washington  
 PROJECT NUMBER C317.0102  
 LOGGED BY Eron Dodak, R.G.  
 DATE October 12, 2006

SAMPLE INFORMATION					Depth (ft)	STRATA	DESCRIPTION
Sample ID	PID (ppm)	Sheen	Sample Time	Sample Depth			
LSP0669	0.4	NS	0835	0-1	2--	ML	Slightly gravelly silt, dk grayish brown (10YR 4/2), 15% F-2" dia. gravel, trace debris (plastic, rags), trace charcoal, some roots, moist, no odor (fill). worms observed from 1-2' bgs.
LSP0670	0.8	NS	0840	1-2		ML	Slightly clayey silt, grayish brown (10YR 4/2) some orange mottling, trace roots, slightly moist, no odor (native).
LSP0671	1.0	NS	0845	2-3			as above w/color brown (10YR 4/3), trace carbonized and non-carbonized organics
LSP0672	0.7	NS	0850	3-4		4--	Test pit terminated at 4 ft bgs
Background PID=0.0 ppm							No evidence of contamination observed

**ADDITIONAL NOTES / SKETCHES**

0-3' samples collected from test pit sidewalls  
 3-4' sample collected from track hoe bucket

EXCAVATING CONTRACTOR	Wilder Construction
EXCAVATION METHOD	Track Hoe
SAMPLING EQUIPMENT	Stainless steel bowl, spoon
COORDINATES	Northings: 649445.565 Eastings: 1235414.311
SURFACE ELEVATION	
DATUM	Horizontal: NAD 83/91

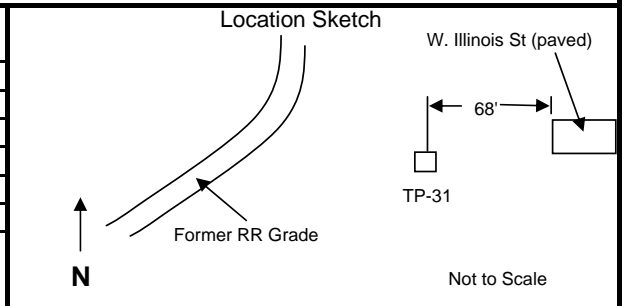



1201 Cornwall Avenue, Suite 208  
Bellingham, WA 98225

(360) 756-9296 FAX (360) 756-7914

HAND AUGER NO. HA-01  
PROJECT Little Squalicum Park RI/FS  
LOCATION Bellingham, Washington  
PROJECT NUMBER C075-02  
LOGGED BY Susan Fitzgerald, P.G.  
DATE April 12, 2006

SAMPLE INFORMATION					Depth (ft)	STRATA	DESCRIPTION
Sample ID	Time	PID/FID	Sheen	Sample Depth (ft)			
LSP0569	0845	0/0	NS	0-1	GM	USCS group name, color, grain size range, minor constituents, plasticity, odor, sheen, moisture content, texture, weathering, cementation, geologic interpretation, etc.	
				1--			
LSP0570	0850	0/0	NS	1-2			
				2--			
				3--			
				4--			
				5--			
				6--			
Background PID = 0.0 ppm, FID = 0.0 ppm.							

SAMPLING EQUIPMENT	3.25" dia. SS hand auger
COORDINATES	Northing: 648110.84 ft
	Eastings: 1234474.56 ft
SURFACE ELEVATION	15.38 ft
DATUMS	Horizontal: NAD 83/91
	Vertical: NAVD 88

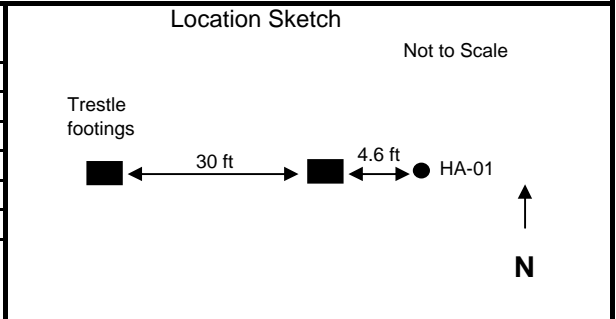



1201 Cornwall Avenue, Suite 208  
 Bellingham, WA 98225  
 (360) 756-9296 FAX (360) 756-7914

HAND AUGER NO. HA-02  
 PROJECT Little Squalicum Park RI/FS  
 LOCATION Bellingham, Washington  
 PROJECT NUMBER C075-02  
 LOGGED BY Susan Fitzgerald, P.G.  
 DATE April 12, 2006

SAMPLE INFORMATION					Depth (ft)	STRATA	DESCRIPTION
Sample ID	Time	PID/FID	Sheen	Sample Depth (ft)			
LSP0571	0930	0/0	NS	0-1	CL	Sandy clay with gravel (30/30/40), v. dark gray (10 YR 3/1), about 25% woody debris, subangular gravel up to 3" dia., fine to coarse sand, moist to wet.	
				1--			
LSP0572	0935	0/2.4	NS	1-2	PT	Silty peat, black (10 YR 2/1), mostly woody detritus, trace sand and fine gravel, 20-30% silt, wet, no odor.	
				2--	—	Boring terminated at 2 ft bgs.	
				3--			
				4--			
				5--			
				6--			
Background PID = 0.0 ppm, FID = 0.0 ppm.							

SAMPLING EQUIPMENT	3.25" dia. SS hand auger
COORDINATES	Northing: 648169.29 ft
	Eastings: 1234375.86 ft
SURFACE ELEVATION	12.27 ft
DATUMS	Horizontal: NAD 83/91
	Vertical: NAVD 88

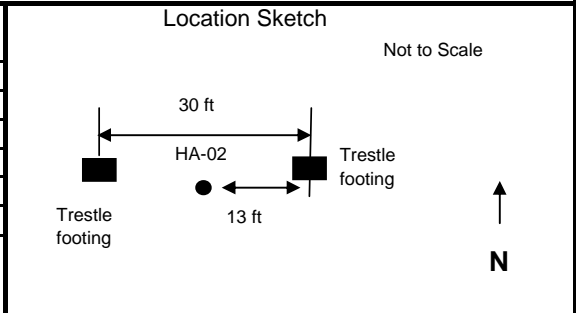



1201 Cornwall Avenue, Suite 208  
 Bellingham, WA 98225  
 (360) 756-9296 FAX (360) 756-7914

HAND AUGER NO. HA-03  
 PROJECT Little Squalicum Park RI/FS  
 LOCATION Bellingham, Washington  
 PROJECT NUMBER C075-02  
 LOGGED BY Susan Fitzgerald, P.G.  
 DATE April 12, 2006

SAMPLE INFORMATION					Depth (ft)	STRATA	DESCRIPTION
Sample ID	Time	PID/FID	Sheen	Sample Depth (ft)			
LSP0573	1050	0/0	NS	0-1	1--	SP/SC	Sand with clay and gravel (35/55/10), v. dark grayish brown, gravel up to 2" dia., subangular to subrounded, fine sand, clay occurs as lenses or beds, trace plant detritus, trace mottling in clay clumps, moist, no odor.
LSP0574	1055	0/0	NS	1-2		SP	Sand with gravel (35/60/5), 2" dia., fine to med. sand, otherwise as above.
					2--		Boring terminated at 2 ft. bgs.
					3--		
					4--		
					5--		
					6--		
Background PID = 0.0 ppm, FID = 0.0 ppm.							

SAMPLING EQUIPMENT	3.25" dia. SS hand auger
COORDINATES	Northing: 648253.39 ft Eastings: 1234242.75 ft
SURFACE ELEVATION	15.53 ft
DATUMS	Horizontal: NAD 83/91 Vertical: NAVD 88

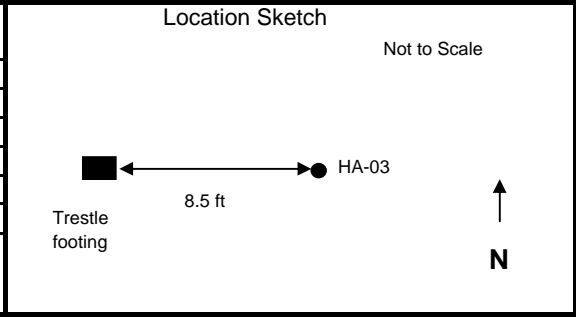



1201 Cornwall Avenue, Suite 208  
 Bellingham, WA 98225  
 (360) 756-9296 FAX (360) 756-7914

HAND AUGER NO. HA-04  
 PROJECT Little Squalicum Park RI/FS  
 LOCATION Bellingham, Washington  
 PROJECT NUMBER C075-02  
 LOGGED BY Susan Fitzgerald, P.G.  
 DATE April 12, 2006

SAMPLE INFORMATION					Depth (ft)	STRATA	DESCRIPTION
Sample ID	Time	PID/FID	Sheen	Sample Depth (ft)			
LSP0575	1110	0/0	NS	0-1	1--	SP	Fine sand (10/90/<5), v. dk grayish brown (10YR 3/2), trace fines, subangular gravel up to 2.5" dia., trace rootlets, moist, no odor.
LSP0576	1115	0/0	NS	1-2		SM	Sand with silt (10/80/10), color as above, similar to above, slightly siltier, silt occurs in lenses and in matrix, gravel up to about 0.5" dia., no odor, moist.
					2--		Boring terminated at 2 ft bgs.
					3--		
					4--		
					5--		
					6--		
Background PID = 0.0 ppm, FID = 0.0 ppm.							

SAMPLING EQUIPMENT	3.25" dia. SS hand auger
COORDINATES	Northing: 648231.38 ft
	Eastings: 1234234.49 ft
SURFACE ELEVATION	13.80 ft
DATUMS	Horizontal: NAD 83/91
	Vertical: NAVD 88

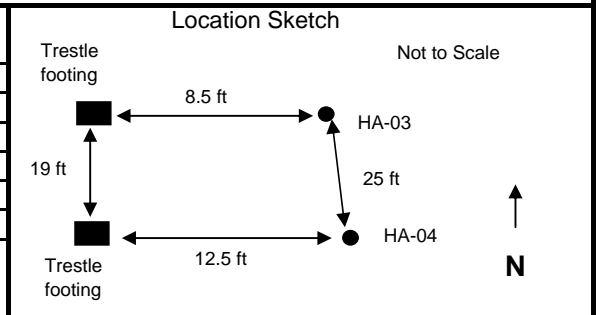



1201 Cornwall Avenue, Suite 208  
 Bellingham, WA 98225  
 (360) 756-9296 FAX (360) 756-7914

HAND AUGER NO. HA-05  
 PROJECT Little Squalicum Park RI/FS  
 LOCATION Bellingham, Washington  
 PROJECT NUMBER C075-02  
 LOGGED BY Susan Fitzgerald, P.G.  
 DATE April 12, 2006

SAMPLE INFORMATION					Depth (ft)	STRATA	DESCRIPTION
Sample ID	Time	PID/FID	Sheen	Sample Depth (ft)			
LSP0577	1015	0/0	NS	0-1	CL/ ML	Silty clay with sand, 20% v. fine to fine sand, black (10 YR 2/1), trace fine subangular gravel, trace glass shards, 15% organics (roots, rootlets), medium to high plasticity, moist, no odor.	
LSP0578	1020	0/0	NS	1-2			
				2--	Boring terminated at 2 ft bgs.		
				3--			
				4--			
				5--			
				6--			
Background PID = 0.0 ppm, FID = 0.0 ppm.							

SAMPLING EQUIPMENT	3.25" dia. SS hand auger
COORDINATES	Northing: 648159.70 ft
	Eastings: 1234349.45 ft
SURFACE ELEVATION	11.69 ft
DATUMS	Horizontal: NAD 83/91
	Vertical: NAVD 88

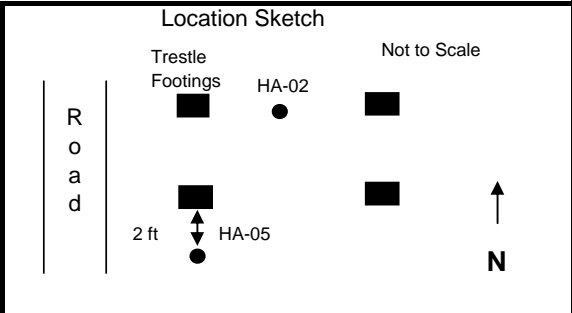



1201 Cornwall Avenue, Suite 208  
 Bellingham, WA 98225  
 (360) 756-9296 FAX (360) 756-7914

HAND AUGER NO.	HA-06
PROJECT	Little Squalicum Park RI/FS
LOCATION	Bellingham, Washington
PROJECT NUMBER	C075-02
LOGGED BY	Susan Fitzgerald, P.G.
DATE	April 12, 2006

SAMPLE INFORMATION					Depth (ft)	STRATA	DESCRIPTION
Sample ID	Time	PID/FID	Sheen	Sample Depth (ft)			
LSP0579	0900	0/0	NS	0-1	GC	Clayey gravel with sand (50/25/25), black (10YR 2/1), subangular to subrounded gravel up to 1.5" dia., fine to coarse sand, ~10% rootlets, several earthworms, moist to wet, no odor.	
LSP0581	0905	-	-	0-1 (dup)			
LSP0580	0910	0/2.4	NS	1-2			
				1--		As above with increased sand content (50/20/30), increased wood debris content, trace glass shards.	
				2--		Boring terminated at 2 ft bgs.	
				3--			
				4--			
				5--			
				6--			
Background PID = 0.0 ppm, FID = 0.0 ppm.							

SAMPLING EQUIPMENT	3.25" dia. SS hand auger
	COORDINATES
	Northing: 648093.36 ft
	Eastings: 1234457.60 ft
SURFACE ELEVATION	13.33 ft
DATUMS	Horizontal: NAD 83/91
	Vertical: NAVD 88

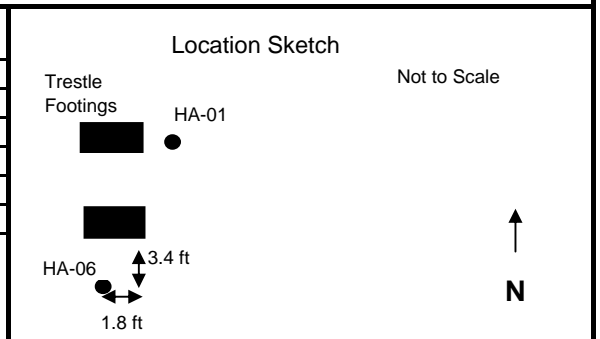



1201 Cornwall Avenue, Suite 208  
 Bellingham, WA 98225  
 (360) 756-9296 FAX (360) 756-7914

HAND AUGER NO. HA-07  
 PROJECT Little Squalicum Park RI/FS  
 LOCATION Bellingham, Washington  
 PROJECT NUMBER C075-02  
 LOGGED BY Eron Dodak, R.G.  
 DATE November 4, 2005

SAMPLE INFORMATION					Depth (ft)	STRATA	DESCRIPTION
Sample ID	Time	PID/FID	Sheen	Sample Depth (ft)			
LSP0015	1445	0.9	NS	0-1	ML	Clayey silt, dark gray (7.5 YR 4/1), 15-20% clay, 5-10% fine to med. sand, ~5% roots, moist, no odor.	
LSP0016	1500	2.0	NS	1-2		Silt with sand, brown (7.5 YR 4/2), 20-25% fine to med. sand, 5-10% clay, v. moist, indistinct to no odor.	
				2--		Water in borings at 1.5 to 2 ft bgs.	
				2--		Boring terminated at 2 ft bgs.	
				3--			
				4--			
				5--			
				6--			

SAMPLING EQUIPMENT	3.25" dia. SS hand auger
COORDINATES	Northing: 649325.59 ft
	Eastings: 1235251.68 ft
SURFACE ELEVATION	35.44 ft
DATUMS	Horizontal: NAD 83/91
	Vertical: NAVD 88

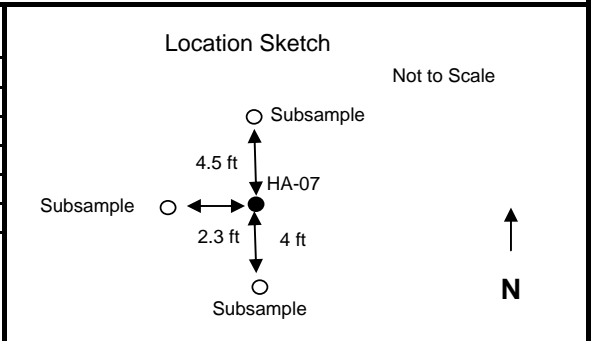



1201 Cornwall Avenue, Suite 208  
 Bellingham, WA 98225  
 (360) 756-9296 FAX (360) 756-7914

HAND AUGER NO. HA-08  
 PROJECT Little Squalicum Park RI/FS  
 LOCATION Bellingham, Washington  
 PROJECT NUMBER C075-02  
 LOGGED BY Eron Dodak, R.G.  
 DATE November 4, 2005

SAMPLE INFORMATION					Depth (ft)	STRATA	DESCRIPTION
Sample ID	Time	PID/FID	Sheen	Sample Depth (ft)			
LSP0017	1550	1.4	NS	0-1	ML	Sandy silt, dark grayish brown (10 YR 4/2), 20-25% fine to med. sand, 10-15% clay, 3-5% roots, moist, no odor.	
LSP0018	1600	1.3	NS	1-2			
				1--	SW	Well graded sand w/ silt and gravel, dark grayish brown (10 YR 4/2), 25-30% fine to coarse subrounded gravel, 10-15% silt, wet, no odor.	
				2--			
				2--	—	Standing water in borings at about 1 ft logs.  Boring terminated at 2 ft. bgs.	
				3--			
				4--			
				5--			
				6--			

SAMPLING EQUIPMENT	3.25" dia. SS hand auger
COORDINATES	Northing: 649359.48 ft Eastings: 1235277.73 ft
SURFACE ELEVATION	36.60 ft
DATUMS	Horizontal: NAD 83/91 Vertical: NAVD 88

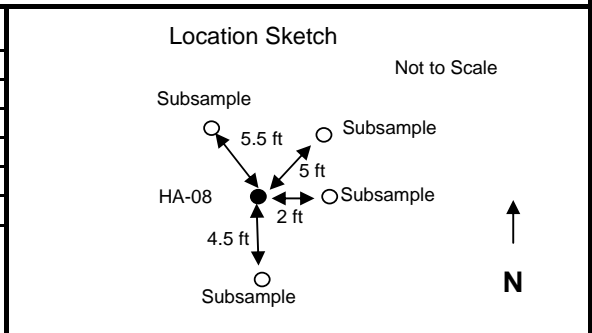



1201 Cornwall Avenue, Suite 208  
Bellingham, WA 98225

(360) 756-9296 FAX (360) 756-7914

HAND AUGER NO. HA-09 (corner of wetland)  
PROJECT Little Squalicum Park RI/FS  
LOCATION Bellingham, Washington  
PROJECT NUMBER C075-02  
LOGGED BY Eron Dodak, R.G.  
DATE February 1, 2006

SAMPLE INFORMATION					Depth (ft)	STRATA	DESCRIPTION
Sample ID	Time	PID/FID	Sheen	Depth			
LSP0119	1645	3.2/102	NS	0-2.5	ML	Clayey silt v. dark brown (10 YR 2/2), 20% roots/wood, soft, wet, sulfur odor.	
				1--		Clayey silt, v. dark grayish brown (10 YR 3/2), ~ 5% roots/some organics, orange mottling, slightly stiff, v. moist, slight sulfur odor.	
				2--		Silty fine sand/sandy silt, v. dark gray (10 YR 3/1), no odor, moist.	
				3--		Refusal at 2.5 ft bgs.	
				4--		Pushed to 2.5 ft in each of 3 cores. Recovery 1.1 to 1.3 ft per core. Sample is a composite of all three cores. Cores collected in a 6 ft area.	
				5--			
				6--			
**Elevated FID reading likely due to methane or sulfate in sediments. Background PID=1.3 ppm.							

SAMPLING EQUIPMENT COORDINATES	2" Push Core
	Station HA-9 was not surveyed.

