

H
G
F
E
D
C
B
A

H
G
F
E
D
C
B
A

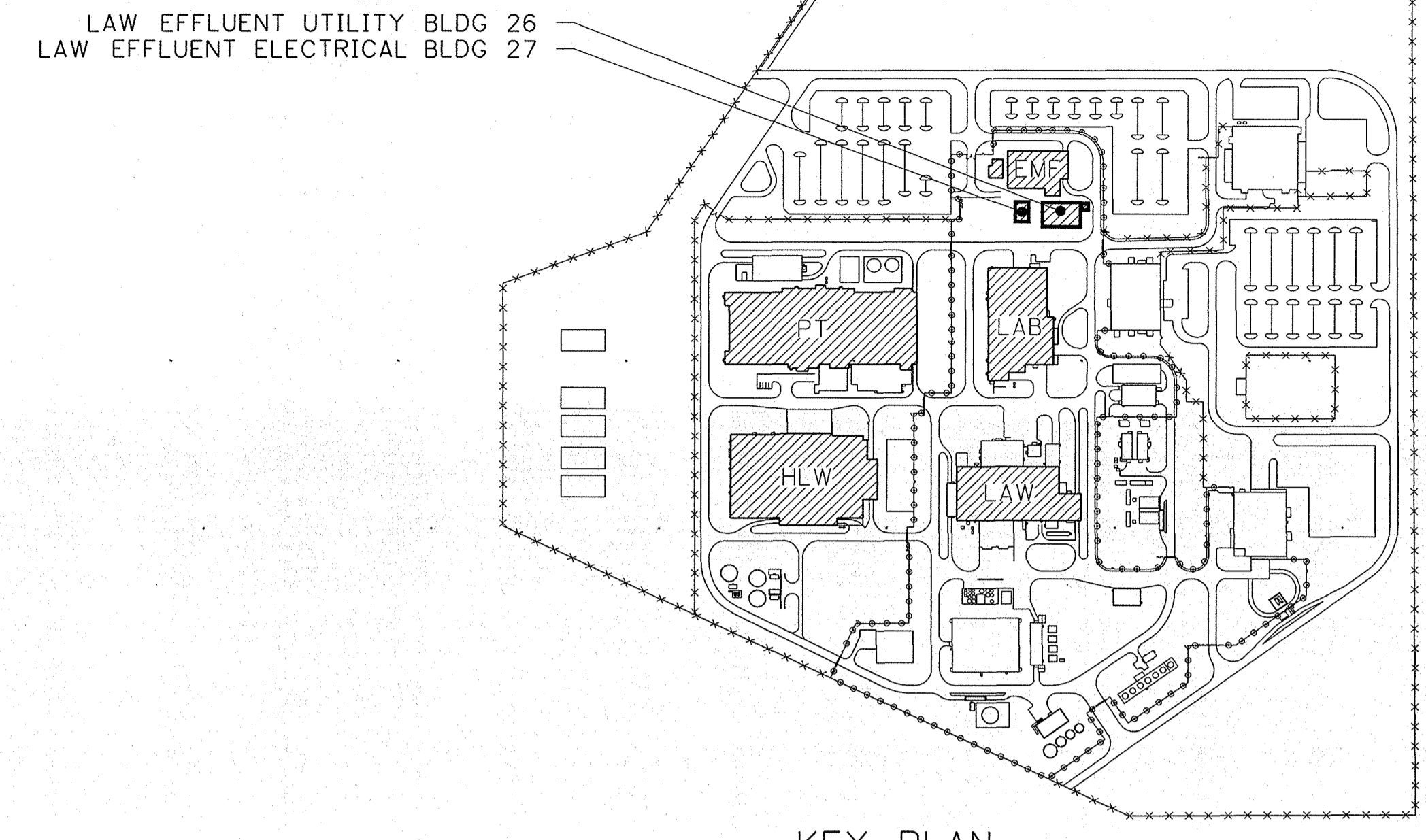
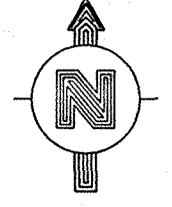
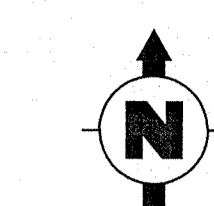

KEY PLAN

GENERAL NOTES:
1. FOR GENERAL NOTES AND LEGEND, SEE 24590-BOF-P1-25-00001.

HOLDS:
1. FIRE RISER ROOM ON HOLD PENDING ELECTRICAL BUILDING SUBCONTRACT AWARD AND DETERMINATION OF SCOPE.

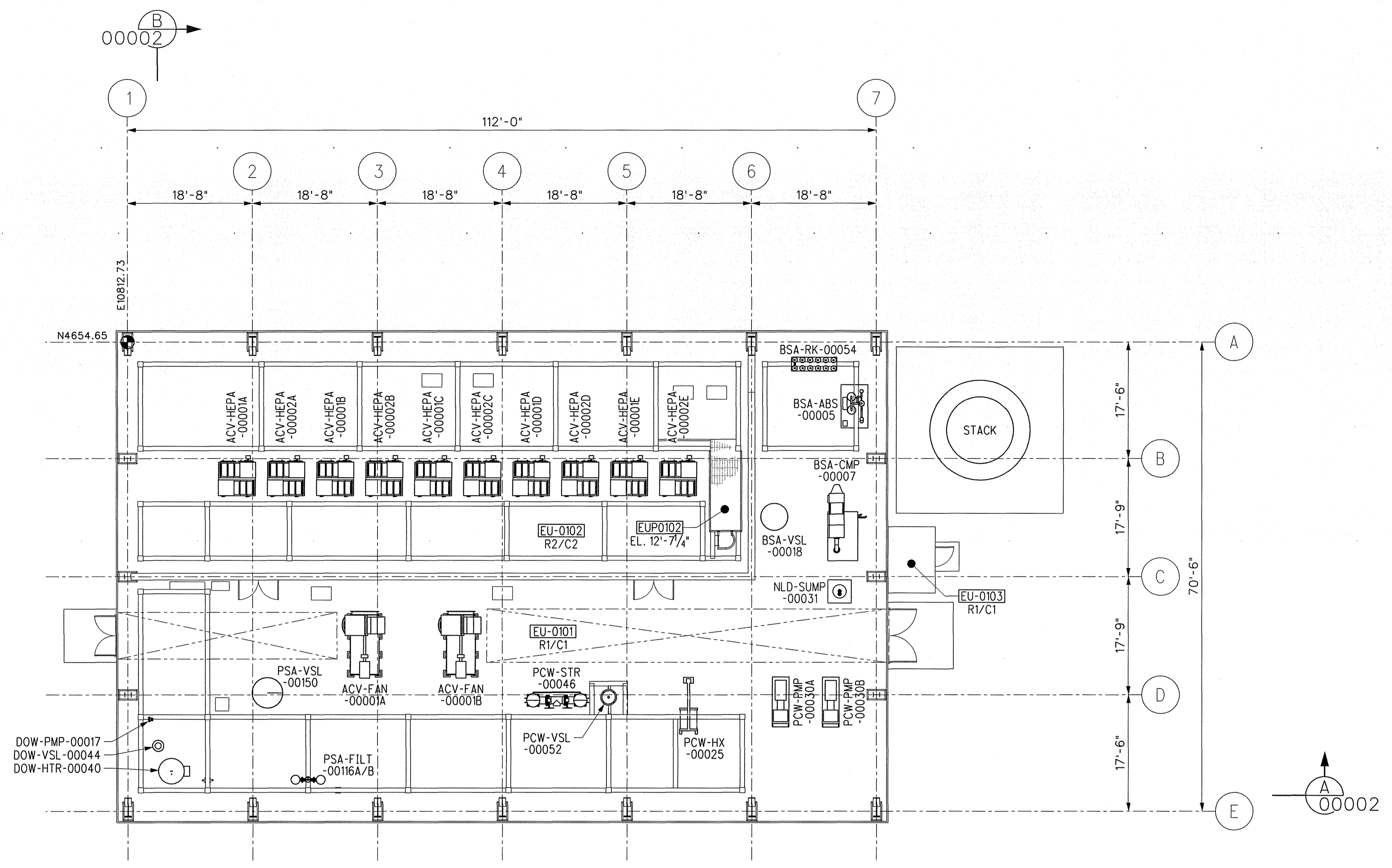
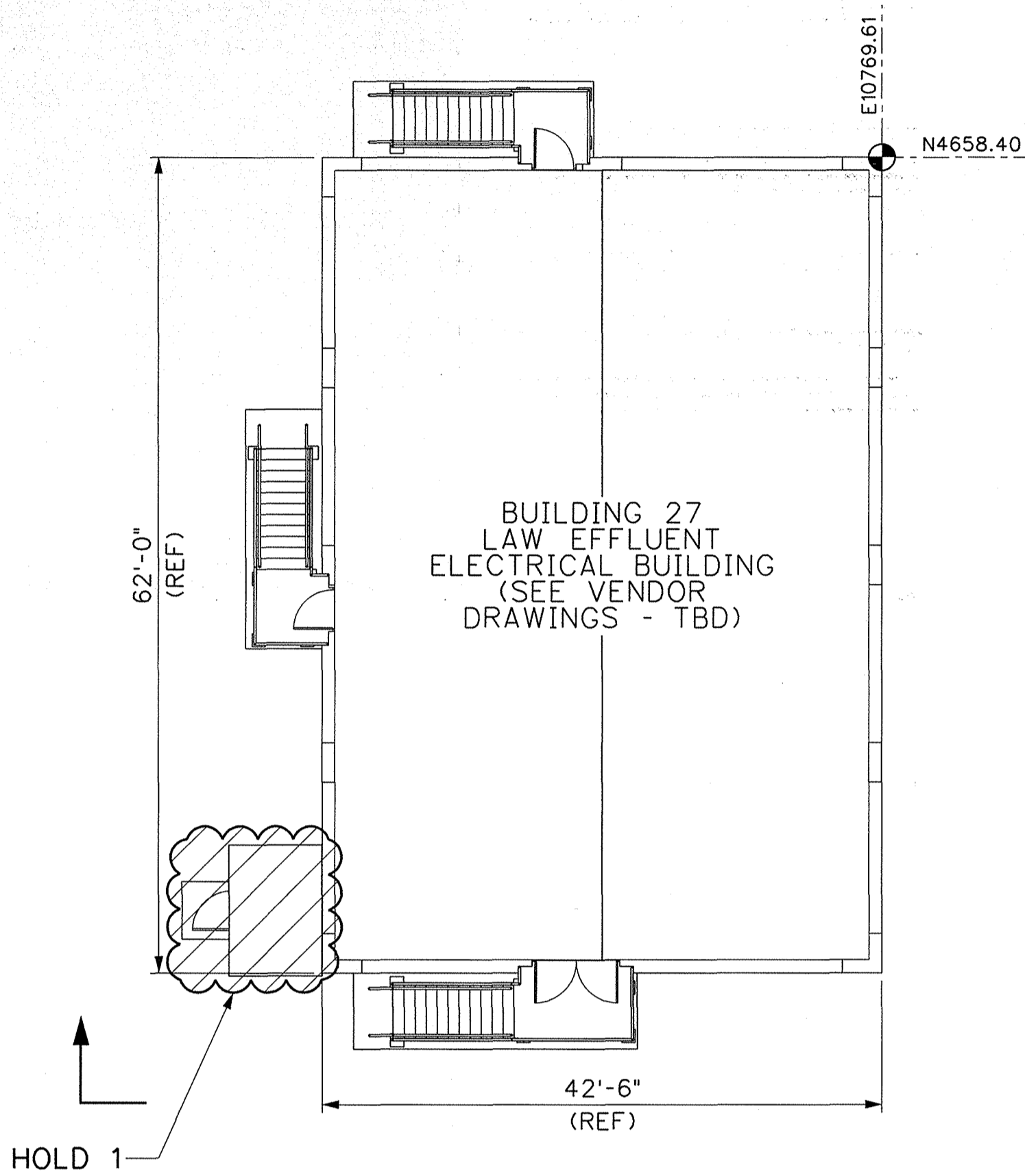

PLAN AT EL. 0'-0"
BUILDING 26

Please note that certain special notices and supplemental materials, as defined in the Atomic Energy Act of 1954 (AEA) are regulated at the U. S. Department of Energy (DOE) facilities exclusively by DOE acting pursuant to its AEA authority. DOE assumes that compliance with AEA, its rules and orders, responsibilities and authority to regulate nuclear, special nuclear, and general materials at DOE-owned nuclear facilities. Information contained herein on radioisotopes is provided for process description purposes only.

REV	DESCRIPTION	ORG	CHKD	RWVD	APVD	DATE
0	ISSUED FOR DESIGN	JTC	SRH	M	SCS	3/1/16

REVISION HISTORY

ISSUED BY	PROJECT No.	24590
CHKD BY	SITE	HANFORD
ISSUE STAMP	AREA	200E
	BUILDING No.	26,27
ORIGINATOR	BY	DATE
CHECKER		
APPROVER		
REVIEWER		

RIVER PROTECTION PROJECT
WASTE TREATMENT PLANT
2435 STEVENS CENTER PLACE
RICHLAND, WA 99354

**BALANCE OF FACILITIES
LAW EFFLUENT UTILITY BLDG &
LAW EFFLUENT ELECTRICAL BLDG
GENERAL ARRANGEMENT
PLAN AT ELEV. 0'-0"**

CONTENT APPLICABLE TO ALARA? YES NO
ADR NO. 24590-BOF-ADR-PL-15-0001 REV: 2

SCALE: 1"=10'-0"
24590-BOF-P1-26-00001
REV 0