

Notes:

1. Elevations are NAVD'88 Datum.
2. Based on Kaiser Drawing Nos. DM-9012-TW and DM-9014-TW.
3. Based on Kaiser Drawing No. DM-10489.
4. Ordinary High Water (OHW) determined by Mike Maher of Ecology on March 2, 2007, and marked with rebar stake.
5. Base map prepared from electronic file provided by Adams & Clark, Inc. titled, "20061102-TOPO.dwg" dated 3/9/07, from survey performed in January 2007.

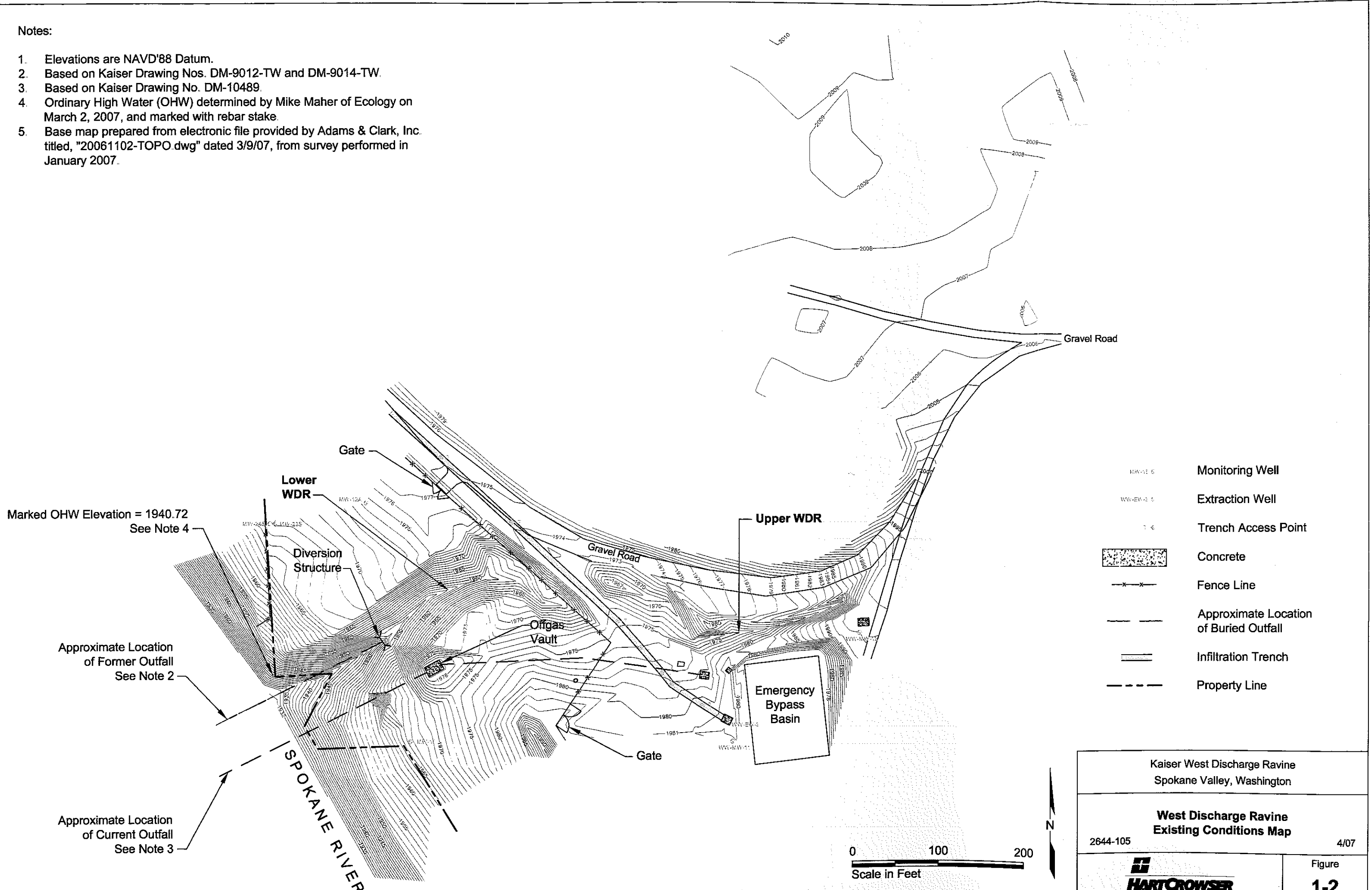

Marked OHW Elevation = 1940.72
See Note 4

Approximate Location
of Former Outfall
See Note 2

Approximate Location
of Current Outfall
See Note 3

- MW-12-6 Monitoring Well
- WW-EV-2-5 Extraction Well
- Trench Access Point
- Concrete
- Fence Line
- Approximate Location of Buried Outfall
- Infiltration Trench
- Property Line

0 100 200
Scale in Feet

Kaiser West Discharge Ravine Spokane Valley, Washington	
West Discharge Ravine Existing Conditions Map	
2644-105	4/07
	Figure 1-2