

Notes:

1. Preserve trees, shrubs, and vegetation to the extent practicable. Removal of suspect soil takes precedence over avoiding vegetation.
2. Install TESC measures prior to earthwork activities on site.
3. Use ditches or other BMPs to prevent up slope surface water running onto slope face of the ravine during construction.
4. See Figure 2-7 for stockpile screening area and loading area BMPs.
5. Interceptor/Filter Berm and silt fence near river shall be moved up ravine as final backfilling in ravine bottom is completed so they are not in the water.

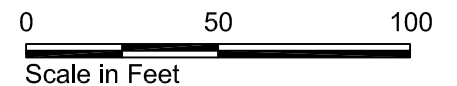
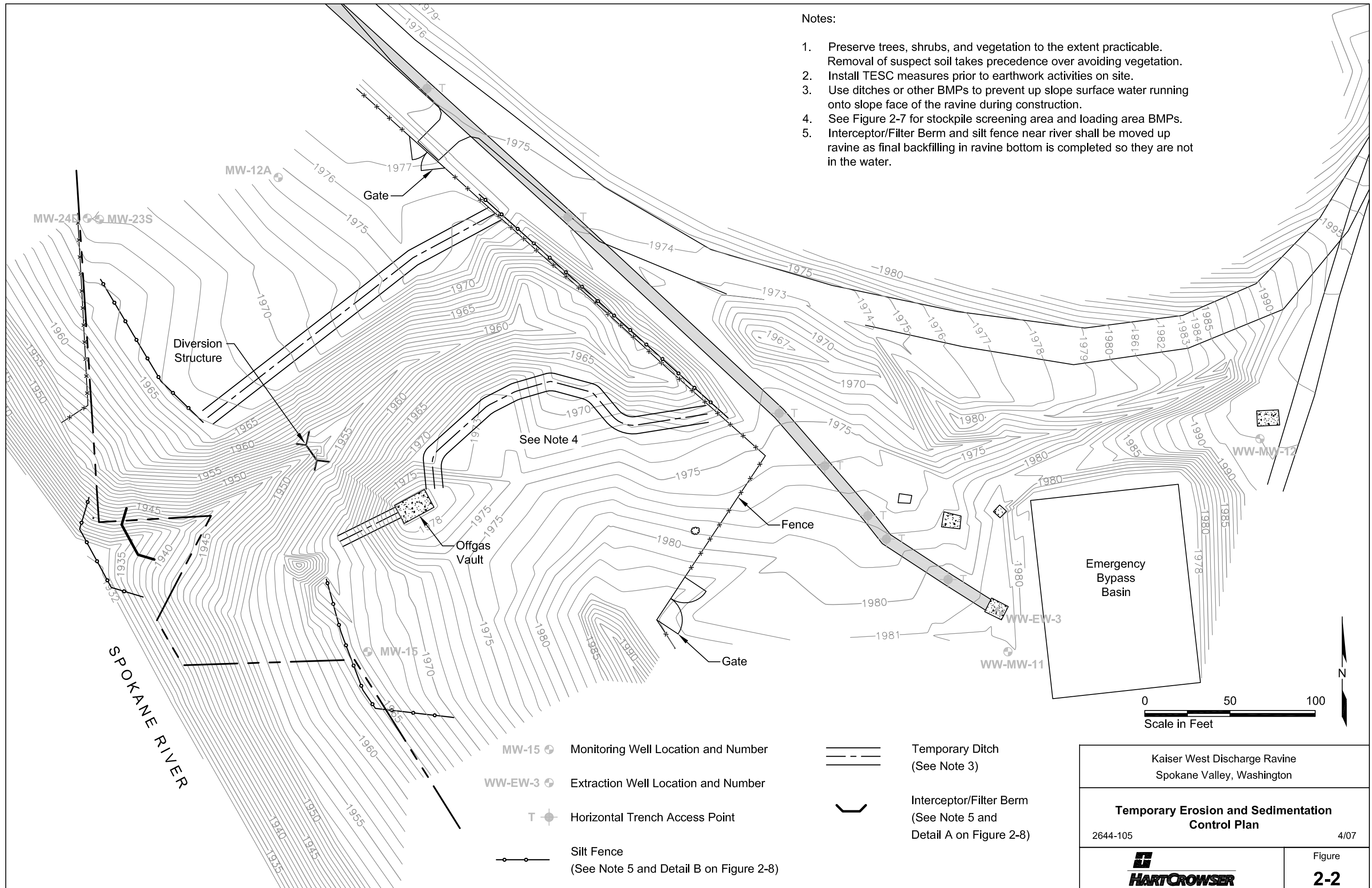

- MW-15 ● Monitoring Well Location and Number
- WW-EW-3 ● Extraction Well Location and Number
- T ● Horizontal Trench Access Point
- Silt Fence (See Note 5 and Detail B on Figure 2-8)
- ==== Temporary Ditch (See Note 3)
- ⌒ Interceptor/Filter Berm (See Note 5 and Detail A on Figure 2-8)

Kaiser West Discharge Ravine Spokane Valley, Washington	
<b>Temporary Erosion and Sedimentation Control Plan</b>	
2644-105	4/07
	Figure <b>2-2</b>