

BNSF RAILWAY SITE SKYKOMISH, WA		AMOUNT OF PETROLEUM REMAINING ON-SITE (ALL ZONES) OVER TIME	
DATE: 6/5/07	DRWN:		FIGURE 10

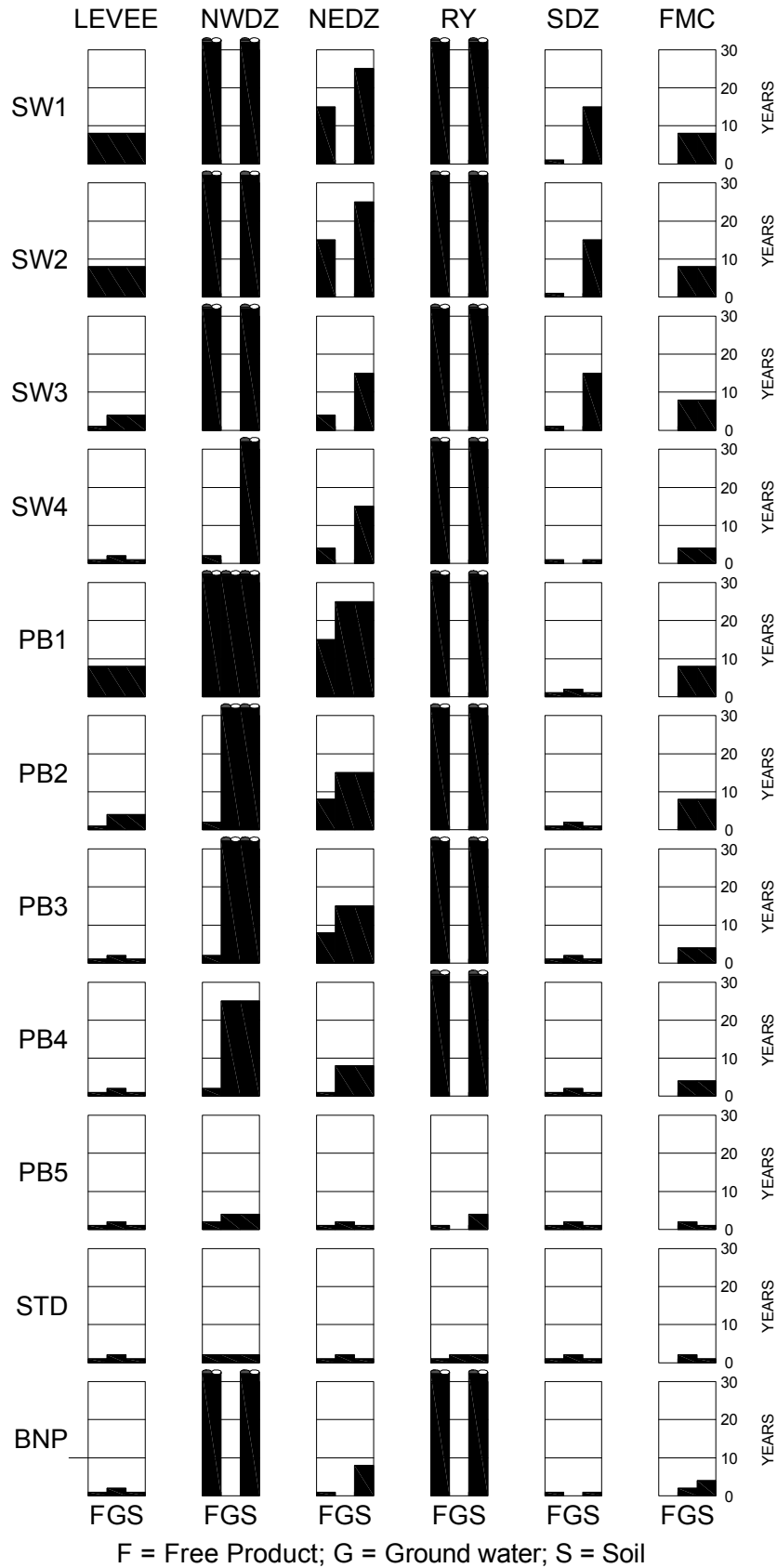

File: H:\16423\ECOLOG\6-4-07\FIG\_12-EVALUATION.dwg Layout: FIGURE 12 User: emarshall Plotted: Jun 05, 2007 - 12:05pm Xref's:

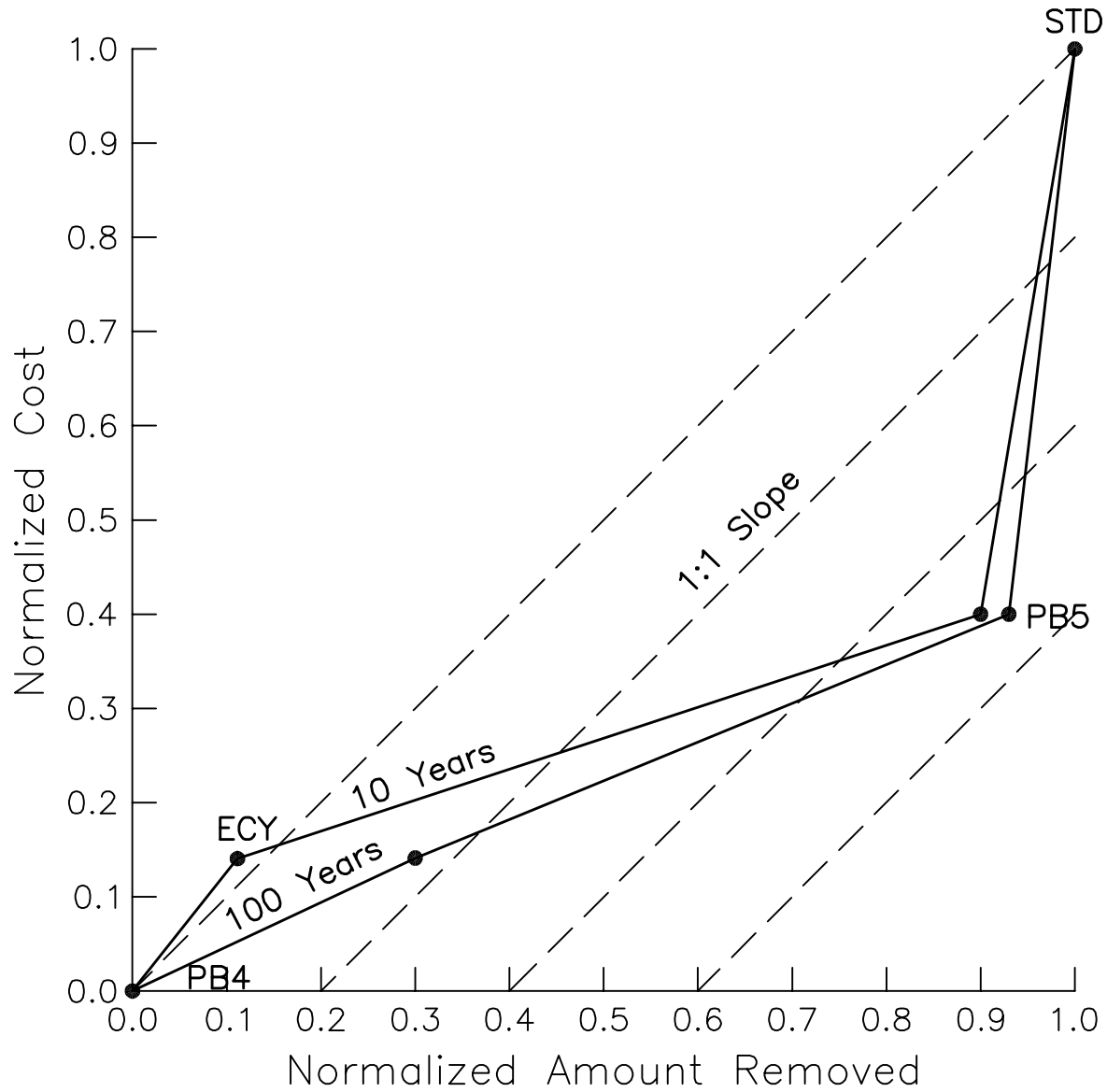

**Note:** PB4 does not meet minimum regulatory requirements and cannot be selected. It is included for comparison purposes only. The cost increase of ECY relative to PB4 is for the cleanup actions which must be added to those in PB4 to develop an alternative which meets the minimum regulatory requirements. See text for further discussion.



BNSF RAILWAY SITE SKYKOMISH, WA		EVALUATION OF PROTECTIVENESS (10 YEARS) AND PERMANENCE (100 YEARS) FOR ALTERNATIVES ECY, PB5, AND STD	
DATE: 6/5/07	DRWN:		FIGURE 12

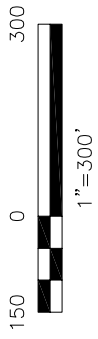
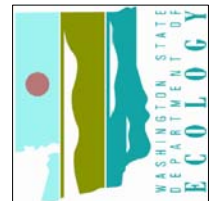
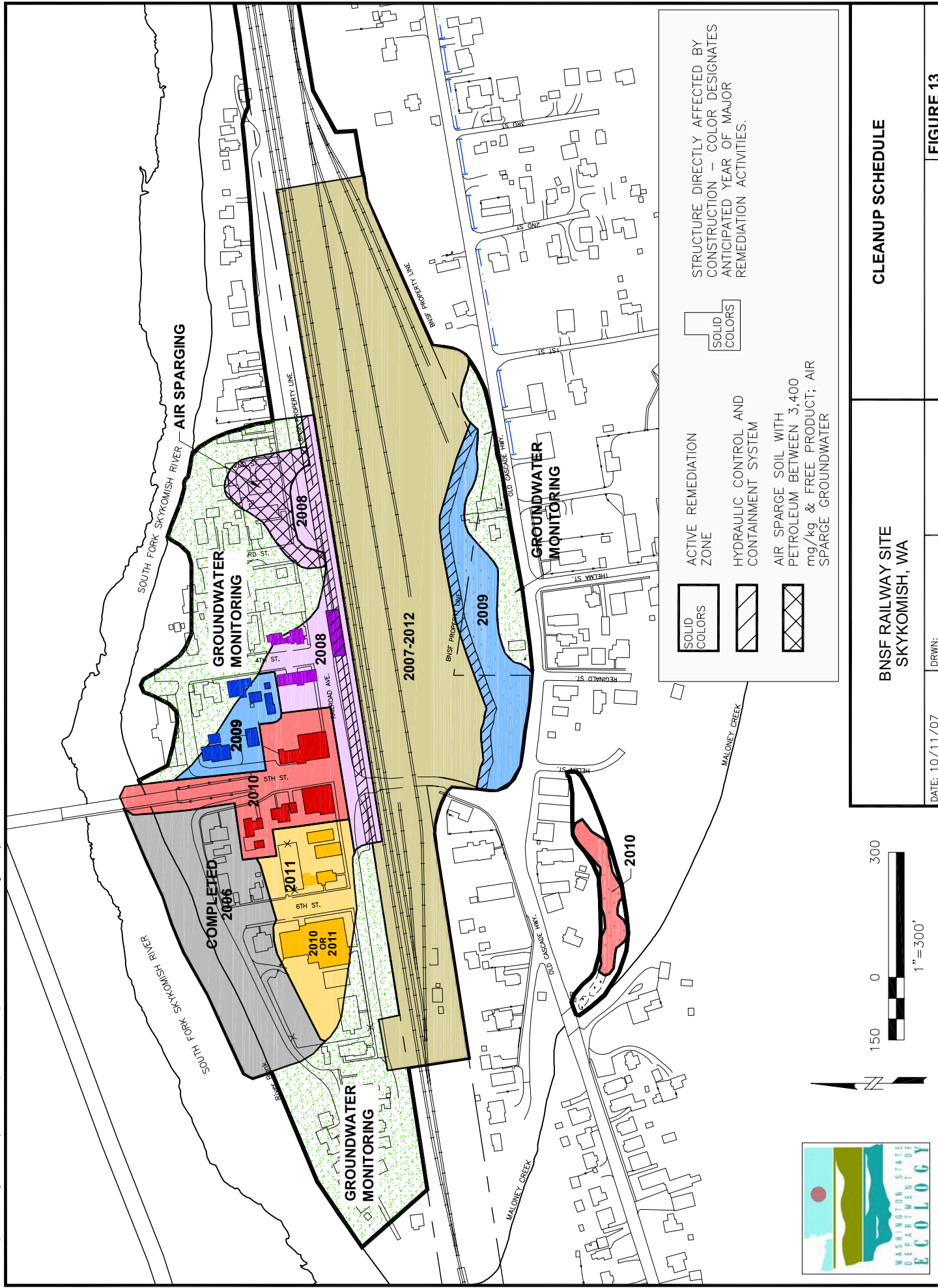



BNSF RAILWAY SITE  
SKYKOMISH, WA

CLEANUP SCHEDULE

DATE: 10/11/07

DRWN:

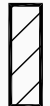
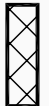
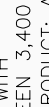
FIGURE 13

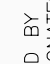
-  SOLID COLORS
-  ACTIVE REMEDIATION ZONE
-  HYDRAULIC CONTROL AND CONTAINMENT SYSTEM
-  AIR SPARGE SOIL WITH PETROLEUM BETWEEN 3,400 mg/kg & FREE PRODUCT; AIR SPARGE GROUNDWATER
-  SOLID COLORS
-  STRUCTURE DIRECTLY AFFECTED BY CONSTRUCTION - COLOR DESIGNATES ANTICIPATED YEAR OF MAJOR REMEDIATION ACTIVITIES.

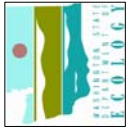
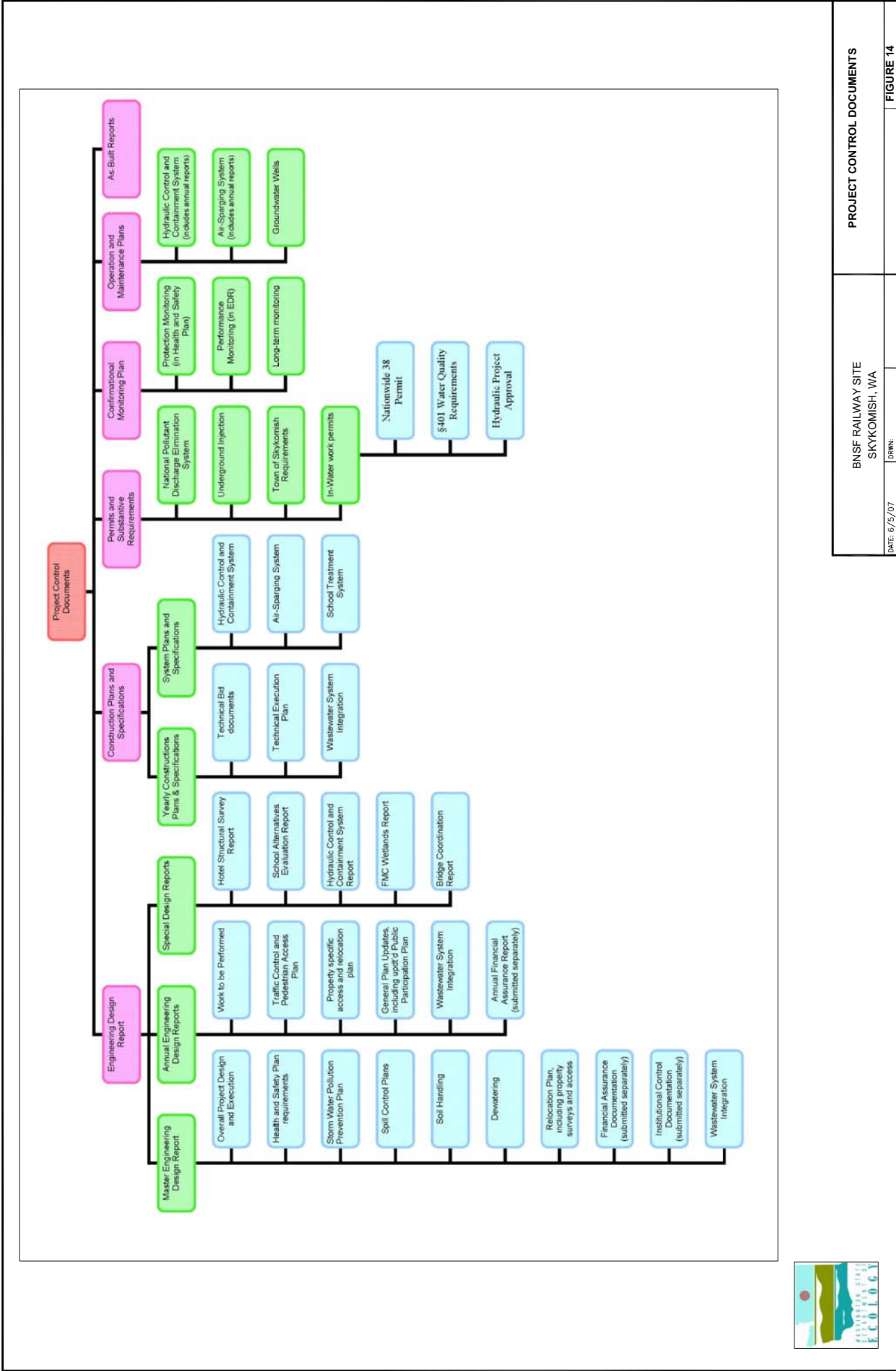

BNSF RAILWAY SITE  
SKYKOMISH, WA

DATE: 6/5/07

FIGURE 14

PROJECT CONTROL DOCUMENTS