

File: H:\BNSF-Skykomish\2008 remediation\X-sects\profile B(3).dwg Layout: C-8 User: emarshall Plotted: Dec 21, 2007 - 8:58am Xref's:

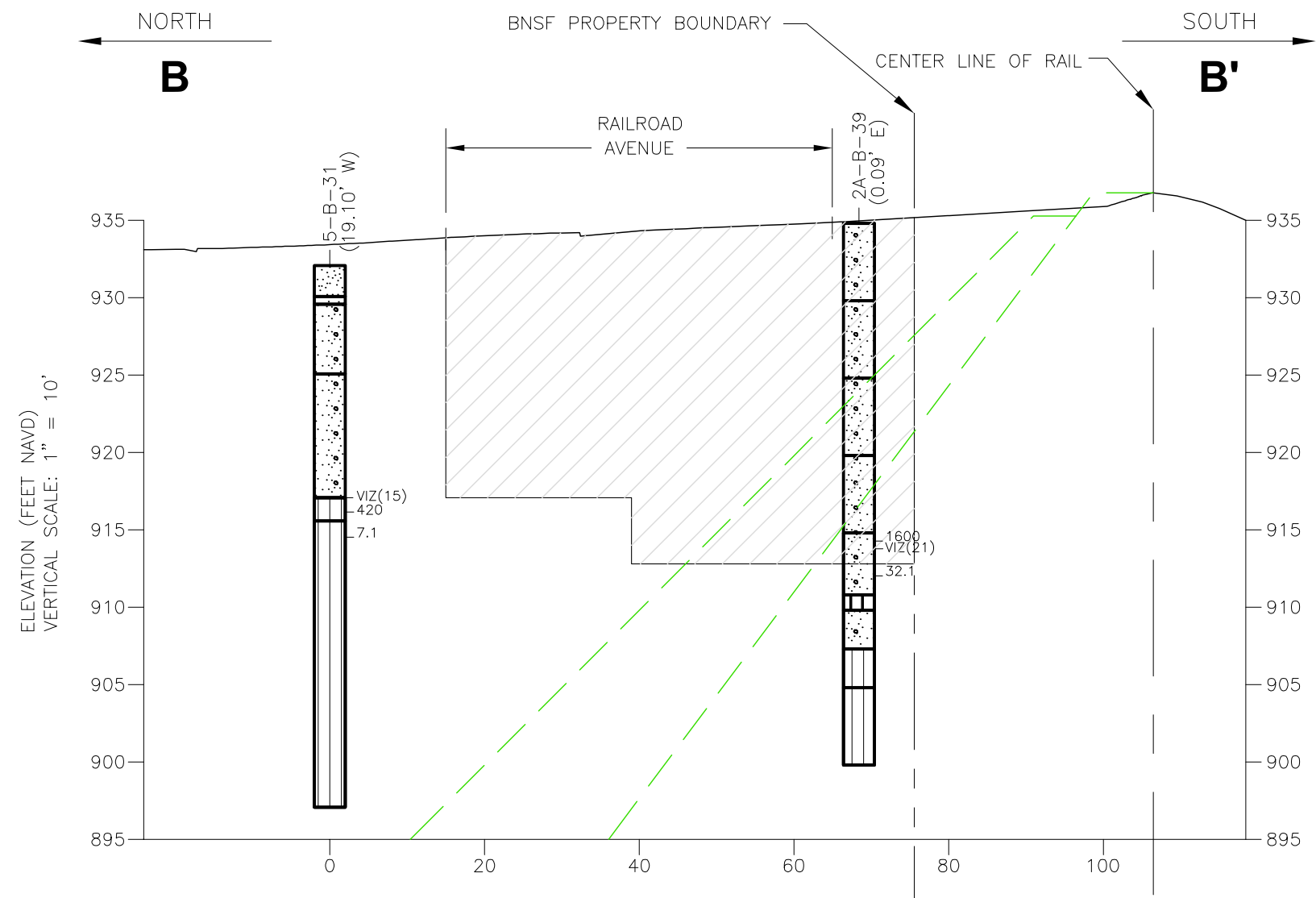

LEGEND

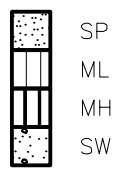

- Excavation Area
- Property Boundary
- Interpolated NWTPH-Dx Isoconcentration Line
- 10,850 NWTPH-Dx (mg/kg) concentration
- vIZ(20) Visual contamination (depth in feet)
- NO vIZ No Visual contamination
- Annual high and low water levels

B-B'
C-6 **CROSS-SECTION**
HORIZONTAL SCALE 1" = 20'

NOTE: Section is projected NORTH to SOUTH

NOTE:

APPROXIMATE EXCAVATION LIMITS WITHIN THE 2008 REMEDIATION BOUNDARY ARE BASED ON OBSERVATIONS DURING SAMPLING AND LABORATORY ANALYTICAL RESULTS. ACTUAL EXCAVATION EXTENTS WITHIN THE 2008 REMEDIATION BOUNDARY WILL BE DETERMINED BASED ON EXCAVATION CONFIRMATION SAMPLING.



THE BNSF RAILWAY COMPANY SKYKOMISH, WASHINGTON 01140-204-0360		SKYKOMISH 2008 EDR EXCAVATION CROSS SECTION B-B'	
DATE: 12/20/07	DRWN: E.M./SEA	DRAWING NO. C-8	