

File: H:\BNSF-Skykomish\2008 remediation\30% drawings\traffic\_plan\_phase\_2(C).dwg Layout: C-25 User: emarshall Plotted: Jan 14, 2008 - 2:26pm Xref's:

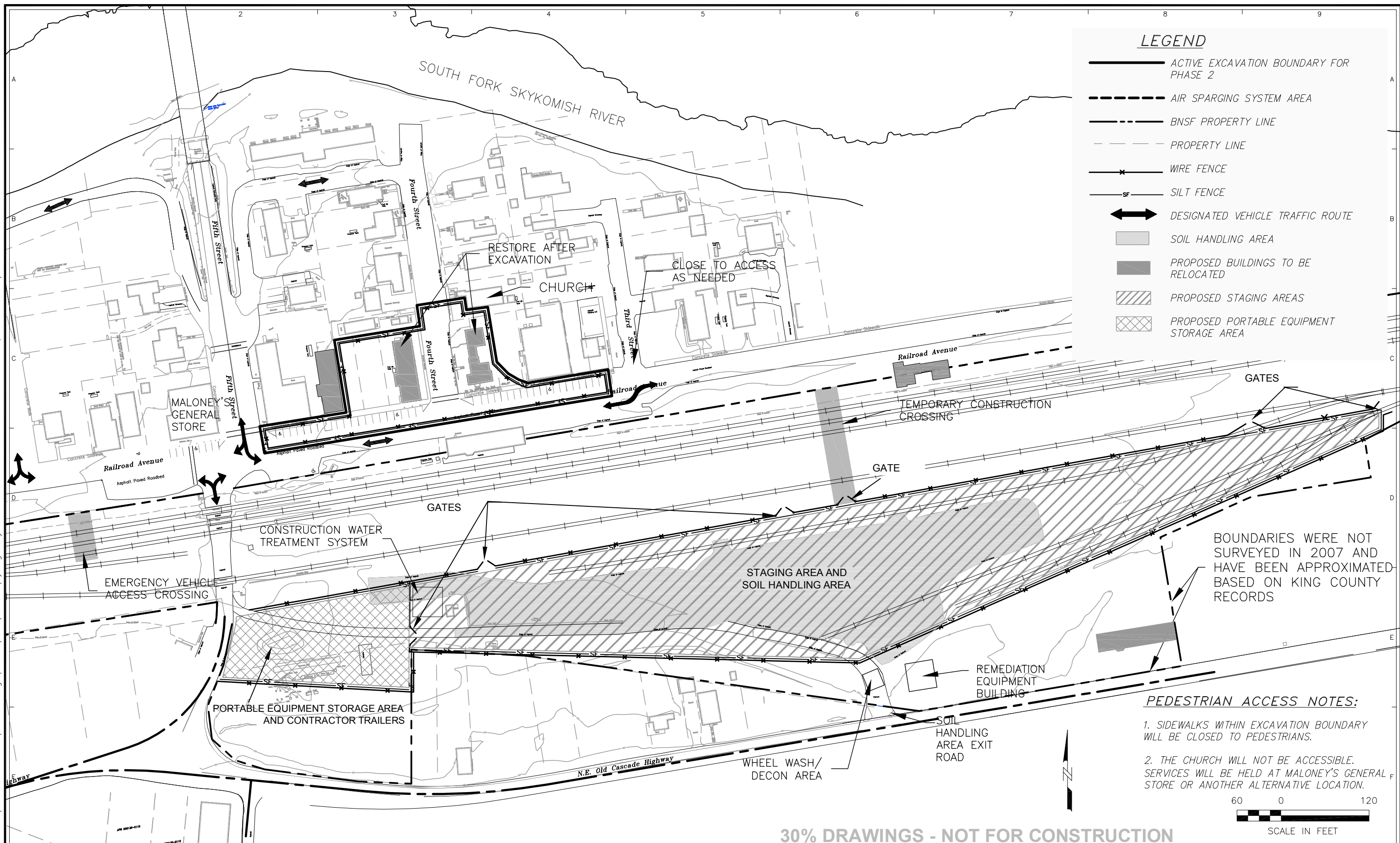

**LEGEND**

- ACTIVE EXCAVATION BOUNDARY FOR PHASE 2
- AIR SPARGING SYSTEM AREA
- BNSF PROPERTY LINE
- PROPERTY LINE
- WIRE FENCE
- SILT FENCE
- DESIGNATED VEHICLE TRAFFIC ROUTE
- SOIL HANDLING AREA
- PROPOSED BUILDINGS TO BE RELOCATED
- PROPOSED STAGING AREAS
- PROPOSED PORTABLE EQUIPMENT STORAGE AREA

**PEDESTRIAN ACCESS NOTES:**

1. SIDEWALKS WITHIN EXCAVATION BOUNDARY WILL BE CLOSED TO PEDESTRIANS.
2. THE CHURCH WILL NOT BE ACCESSIBLE. SERVICES WILL BE HELD AT MALONEY'S GENERAL STORE OR ANOTHER ALTERNATIVE LOCATION.



**30% DRAWINGS - NOT FOR CONSTRUCTION**

				THE BNSF RAILWAY COMPANY SKYKOMISH, WASHINGTON 01140-204-270		SKYKOMISH 2008 EDR PHASE 2 TRAFFIC ROUTING AND PEDESTRIAN ACCESS	
NO	DRWN	DATE	REVISION	CHKD	DATE	APPVD	DATE
	B	EM	12/20/07				
	A	EM	11/9/07				
				CURRENT DATE	12/20/07	DRAWING NO.	C-25
						REVISION	