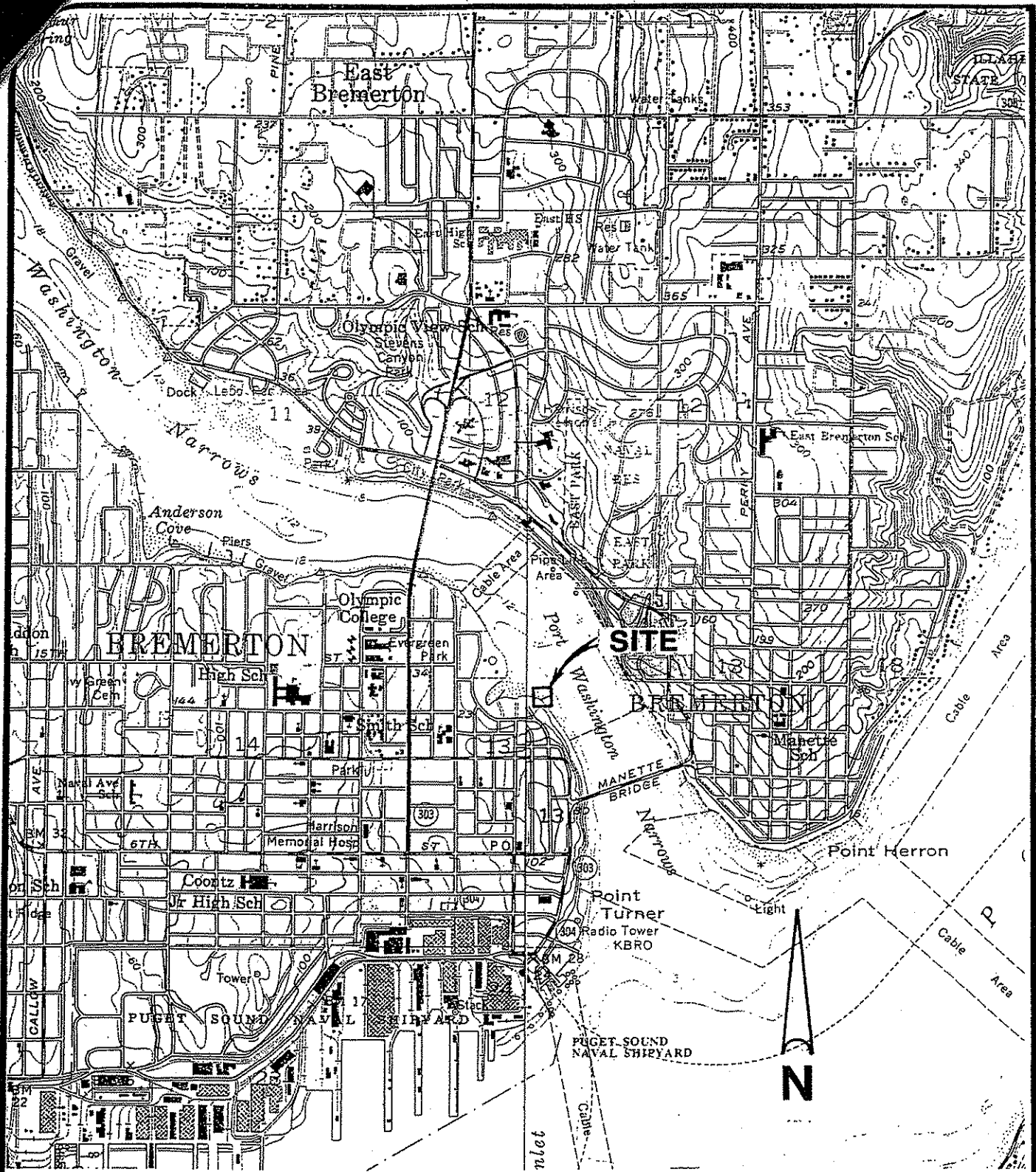
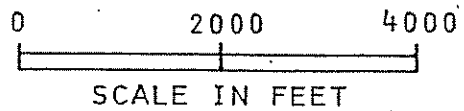

EXHIBIT - A





REFERENCE: USGS 7.5' TOPOGRAPHIC QUADRANGLE SHEETS "BREMERTON EAST, WASH." AND "BREMERTON WEST, WASH."



Search Results

[New Search](#)

Map	Data Change Request	Assessor Data	Sales Data	Permit Data	Tax Statement	Tax Account Number	Taxpayer	Taxpayer Address	Section Township Range	Account Status	Site Address
		GO	GO	GO	GO	3709-001-003-0102 (1422765)	CITY OF BREMERTON	345 6TH STREET STE 600 BREMERTON WA 98337	NW/4 13 24N 1E	A	1310 HIGHLAND AVE

Tax Statement

Home | Departments | Elected Officials | County Services | Resources | Environmental | Elections/Licenses | Parks & Recreation

View: [Receipt\(s\) on file](#)
[\[Click here to Print\]](#)

[\[Click here to Pay by Credit Card\]](#)
[\[Click here to Pay by E-Check\]](#)



Barbara Stephenson
 MAKE REMITTANCES PAYABLE TO:
 Kitsap County Treasurer
 PO Box 34303 Seattle, Washington 98124

2006 WEB TAX STATEMENT

Printed: 10/25/2006

CITY OF BREMERTON
 345 6TH STREET STE 600
 BREMERTON, WA 98337

Account Number	For Informational Purposes Only
3709-001-003-0102	Process Number 1422765
	Taxpayer Name: CITY OF BREMERTON

GENERAL TAX DISTRIBUTION			
	2005	2006	
2005 Total:	\$.00	2006 Total:	\$.00

Tax Property Description
 BAYVIEW ADDN
 BLK 001 LOT 3 NLY 104FT ALSO LOTS 4 & 5 TGW TH TPN OF BLK 6 LOT 1
 DAF BAT SE COR BLK 4 BAYVIEW TH N37*49'W 133.53FT TH N23*00'W
 60.6FT TO X MEA LN & TPOB TH N23*00'W ALG SWLY MGN HIGHLAND
 PROJ NLY 105FT M/L TO X WITH LN 50FT DIST MEAS AT R/A SELY FR
 CTRLN OF EXT TRANSMISSION LN SD TRANS LN DAF BAT MON AT PAC
 & 11TH ST TH N00*38'W ALG CTRLN PAC 778.42FT TO X CTRLN OF
 TRANS LN CROSSING WH BEARS N44*15' FR SD PT ON SWLY MGN
 HIGHLAND AVE PROJ NLY N44*15'E PLT & 50FT DIST SELY FR CTR

VALUE INFORMATION FOR TAX			
	2005		2006
Land:	\$199,420		\$221,360
Improvements:	\$0		\$0
TOTAL VALUE:	\$199,420		\$221,360
Frozen Base:	\$0		\$0
Exemptions (if any):			
Total Qualifying Exemptions:	\$0		\$0

Current Taxes			
	2005	2006	
ASSESSMENT			
Noxious Weed	\$1.02		\$1.02
Asmt Total	\$1.02		\$1.02

2006 General Property Tax + Assessments = \$1,460.26

Delinquent Section			
Year	Taxes	Int/Pen to 10/2006	Total
			\$0.00
Total Delinquent Amt Due:			\$0.00
Total Collection Cost:			\$0.00

TOTAL TAXABLE VALUE:(Land + Improvements minus Qualifying Exemptions)
 \$199,420

Levy Code 0010 General Levy Rate per \$1000 11.6241
 Voted Rate - 36.2 % Voter Approved

TOTAL AMOUNT DUE: \$173.21

First half taxes paid after April 30th will incur interest plus penalty computed on the FULL year amount (RCW 84.56.020).

Account Number: 3709-001-003-0102 (1422765) Parcel Location: 1310 HIGHLAND AVE
 SECOND HALF - Pay or Postmark by October 31

If you did not make a first half payment or pay the delinquent taxes listed, if any, call (360) 337-7135 for delinquent tax, interest and penalty due. Delinquent payments received without interest and penalty will be returned. See Treasurer Information link.

2

	TAX YEAR	Prev Tax Owning	Interest/ Penalty	TOTAL	
				Full	Half
Current:	2006				\$173.21
Delinquent:					\$0.00
Amount Due:					\$173.21

CITY OF BREMERTON
 345 6TH STREET STE 600
 BREMERTON, WA 98337

Make Remittance Payable To
 Kitsap County Treasurer - PO Box 34303 - Seattle, WA 98124



KITSAP COUNTY

GEOGRAPHIC INFORMATION SYSTEM

All Catalogs



614, Division Street,
Port Orchard, WA 98151

- Home
- Departments / Offices
- Services
- A to Z index
- Data Tools
- Employment
- File

Applications

- Parcel Search
- Hazard Locators
- Voter Information

Maps & Data

- Map Library
- Download Data
- Section Downloads
- Data Change Request

Resources

- What is GIS?
- Quick Facts
- Site Map
- Related Links

GIS Home

- Contact Us
- Location
- Directions
- Parking
- Comments

KITSAP COUNTY PARCEL SEARCH

Zoom to an area:

WA

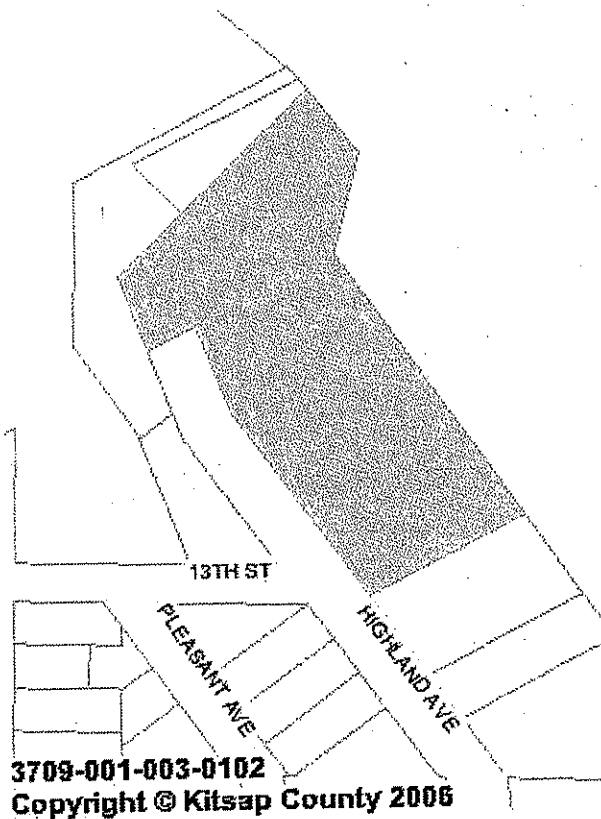

Search by Tax Account

A full or partial tax account number

Search by Address

Do NOT enter Street Direction (E, St., Ave., Blvd., etc.). A list of potentials displayed.

Show 2005 V

Shr

Last Updated:
June 28, 2006

Copyright © 1995-2006 Kitsap County GIS. All rights reserved.
[Privacy Policy](#) [Disclaimer](#) [Comments/email](#)