

ATTACHMENT - 7

REPORT OF GEOTECHNICAL SERVICES
SUBSURFACE CONTAMINATION STUDY
CHEVRON BULK FUEL TERMINAL
BREMERTON, WASHINGTON
FOR CHEVRON, U.S.A.
FILE NO. 0372-34-4

TABLE 1
SUMMARY OF SOIL ANALYTICAL CHEMISTRY DATA

Location	Gasoline	Diesel		Benzene (ppb)	Toluene (ppb)	Ethyl- benzene (ppb)	Total Xylenes (ppb)
	(ppm)	#1 (ppm)	#2 (ppm)				
B-3	66	<10	<10				
MW-4	630	<10	100	<10	15,000	3,100	12,400
MW-5	4,300	17,000	<10	3,400	9,400	2,600	6,800
MW-6	230	71	<10	<10	8,700	2,300	10,500
MW-7	<1	<10	<10	<10	27	66	<10
MW-8	900	<10	200	<10	39,000	110,000	37,000
MW-9	<1	<10	<10	<10	<10	<10	29
MW-10	<1	<10	<10	<10	<10	<10	<10
MW-11	3	<10	480	<10	<10	<10	<10
MW-12	220	<10	210	<10	<10	<10	520
TP-1	250	<10	1,400	<10	<10	169	15
TP-2	31	<10	74	<10	<10	201	15
TP-3	81	<10	250	<10	<10	88	680
TP-4	<1	<10	<10	<1	<1	<1	<1
TP-5	<1	<10	<10	<1	<1	<1	<1
TP-6	4	<10	82	<10	<10	<10	41
TP-7	280	<10	47	<10	6,100	2,400	2,300

TABLE 2
SUMMARY OF GROUND WATER ANALYTICAL CHEMISTRY DATA

Location	Total Petroleum Hydrocarbons (PHM)	Benzene (ppb)	Toluene (ppb)	Ethylbenzene (ppb)	Total Xylenes (ppb)
MW-4	a.	<100	<100	3,600	23,000
MW-5	46.4	1,900	360	290	1,900
MW-6	36.7	2,000	1,500	150	4,300
MW-7	76.7	<1	<1	62	21
MW-8	1,742	3,900	19,000	2,900	18,000
MW-9	38.9	6,100	11,000	1,400	9,800
MW-10	150	<1	<1	350	110
MW-11	<10	<1	<1	<1	<1
MW-12	<10	<1	<1	11	<1

Notes:

a. Sample contained 75% naphtha

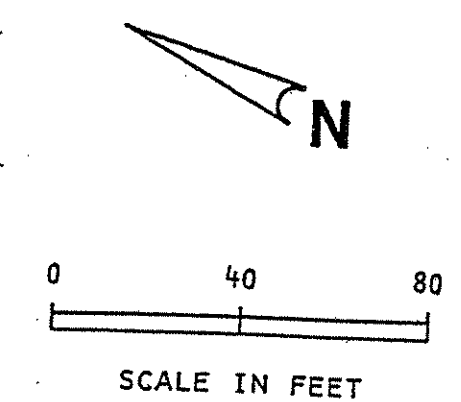
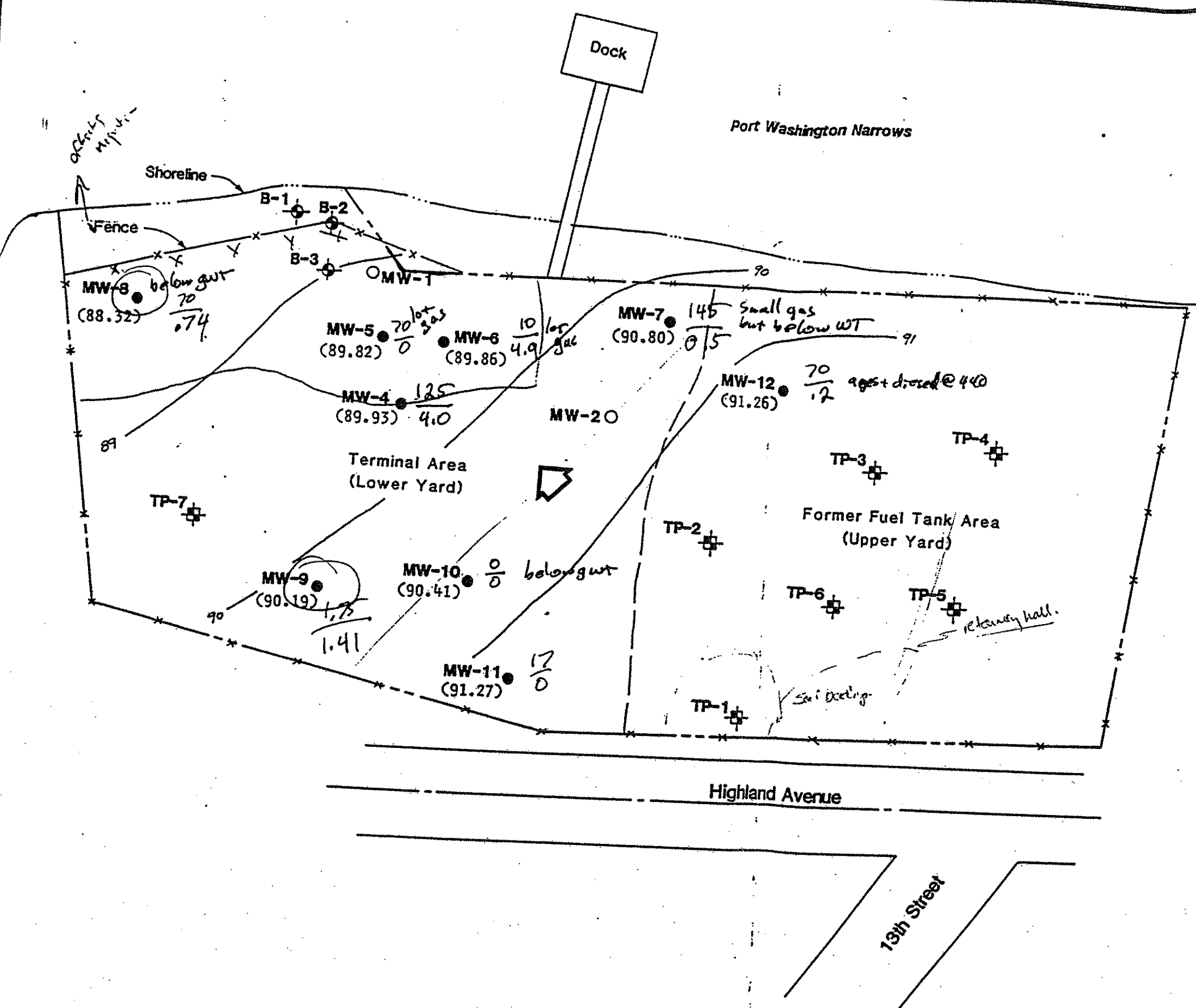

- EXPLANATION:**
- B-1 BORING LOCATION AND NUMBER
 - MW-4 MONITOR WELL LOCATION AND NUMBER
 - TP-1 BACKHOE PIT LOCATION AND NUMBER
 - (89.92) RELATIVE GROUND WATER ELEVATION ON 10/12/88
 - GROUND WATER FLOW DIRECTION
 - MW-10 MONITOR WELL INSTALLED JULY, 1976 BY GEOENGINEERS
 - ⁹¹ WATER TABLE ELEVATION CONTOURS BASED ON 10/12/88 MEASUREMENTS
 - 70 ← Ann wellhead
 - 2.4 Prod thick

REFERENCE: DRAWING ENTITLED "GROUND PLAN", DATED 10/16/70 REVISED, BY STANDARD OIL COMPANY OF CALIFORNIA.



SITE PLAN

FIGURE 2

W72-54-4 Encl: KY 10-1-88