

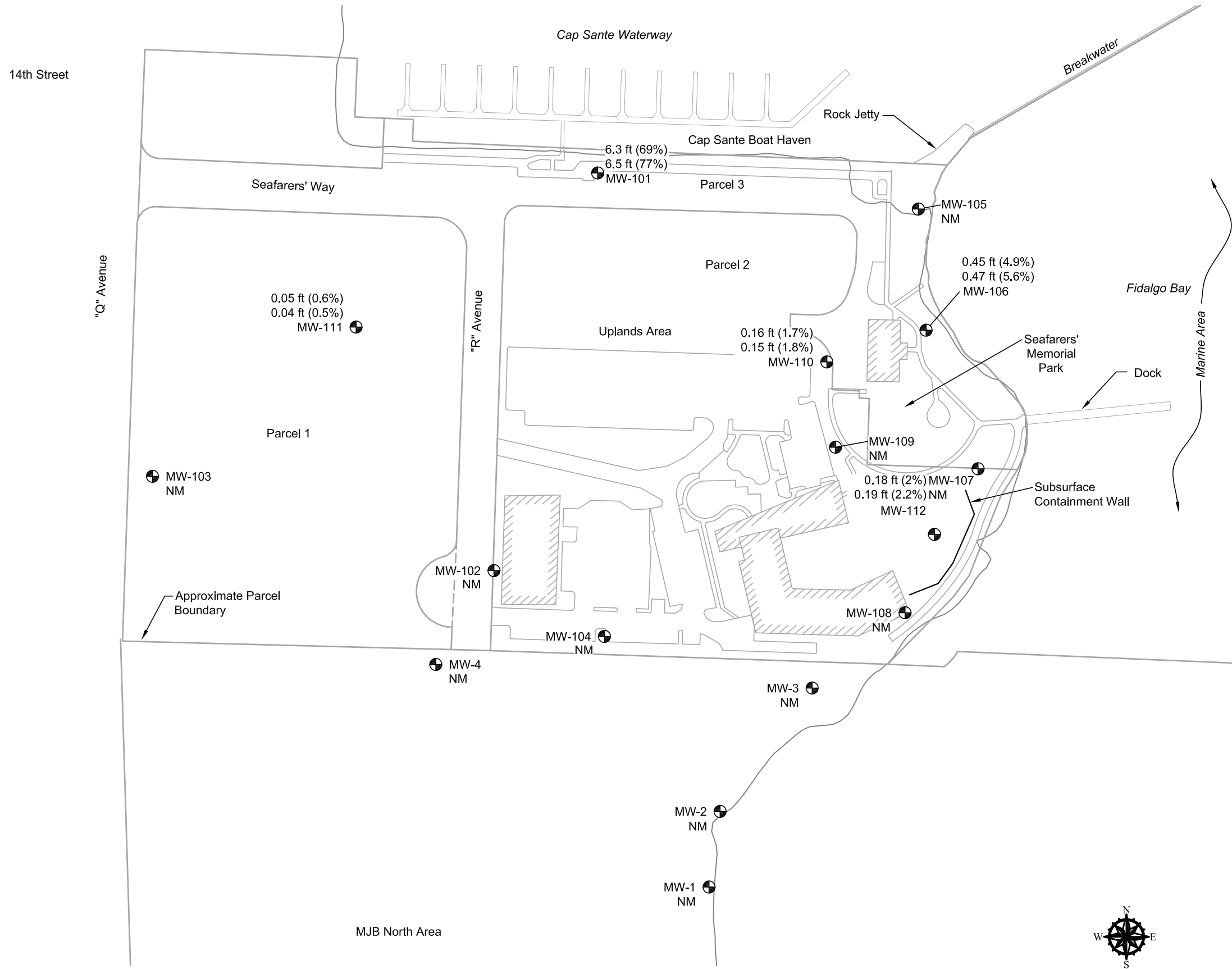



W:\SEATTLE\PROJECTS\5\4\7007\02\CAD\RI-CURRENT FIGURES\5\4\7007\02\F26-28-29-30.DWG\TAB.F26 MODIFIED BY LKNOWLTON ON APR 07, 2008 - 13:44



- Legend**
-  Buildings
 -  Monitoring Well with Designation and Groundwater Elevation
 - 0.45 ft Groundwater Level Fluctuation between High and Low Tide
 - (4.9%) Calculated Tidal Efficiency
 - NM Water Levels Not Monitored During Tidal Study

Tidal Influence on Groundwater Levels	
Scott Paper Mill Anacortes, Washington	
	Figure 26

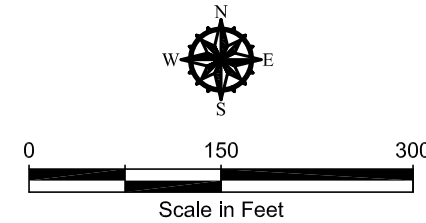

Source: AutoCAD drawing "Figure ZZ", dated 06/13/2007, provided by Landau Associates.
Base map source: Comprehensive Evaluation of Existing Data, Anchor Environmental L.L.C., March 2002.