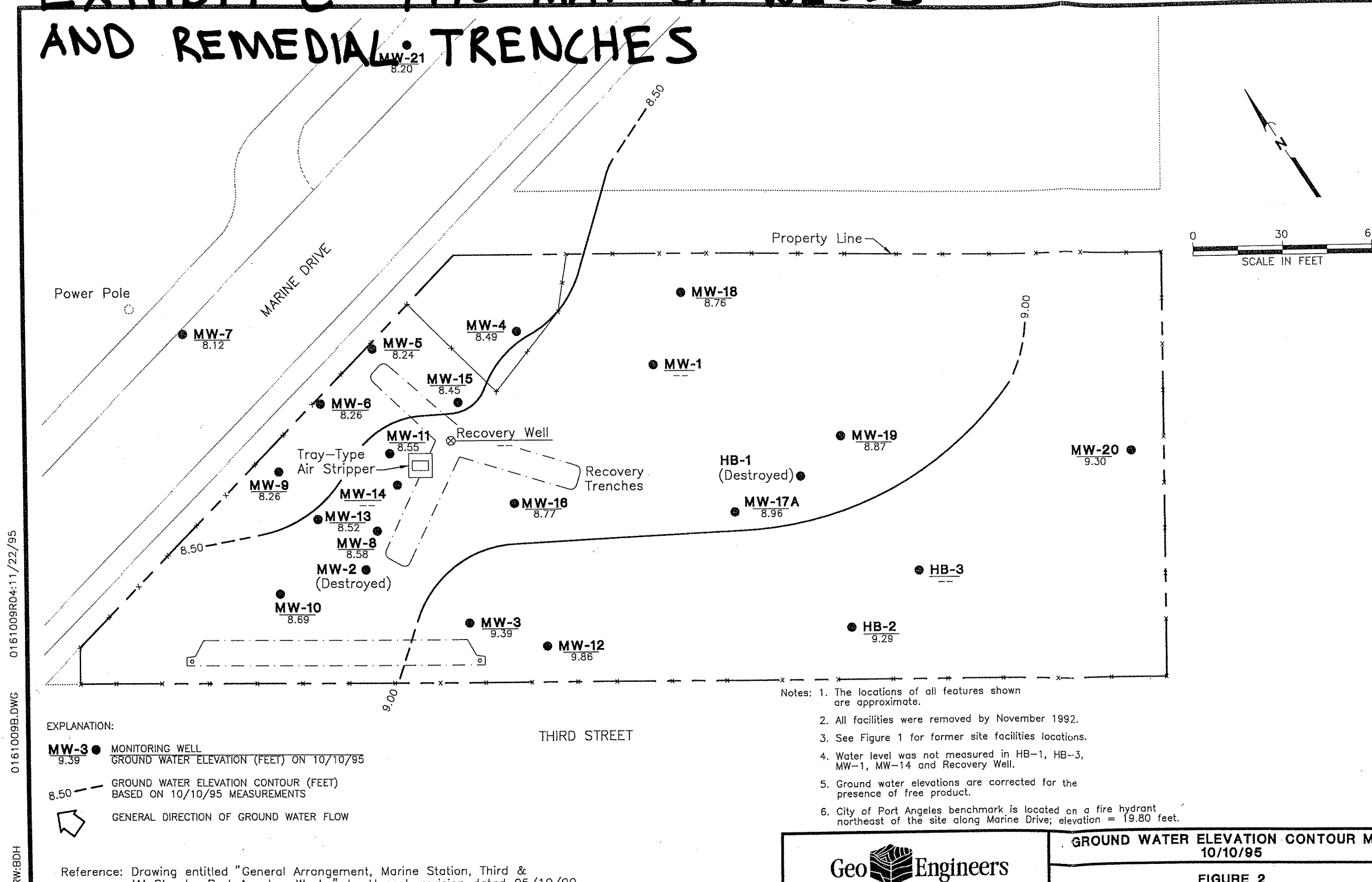

EXHIBIT C - 1995 MAP OF WELLS AND REMEDIAL TRENCHES



0161009B.DWG 0161009R04:11/22/95 CRW:BDH

EXPLANATION:

- MW-3** ● MONITORING WELL
9.39 GROUND WATER ELEVATION (FEET) ON 10/10/95
- 8.50 --- GROUND WATER ELEVATION CONTOUR (FEET)
BASED ON 10/10/95 MEASUREMENTS
- ➔ GENERAL DIRECTION OF GROUND WATER FLOW

- Notes:
1. The locations of all features shown are approximate.
 2. All facilities were removed by November 1992.
 3. See Figure 1 for former site facilities locations.
 4. Water level was not measured in HB-1, HB-3, MW-1, MW-14 and Recovery Well.
 5. Ground water elevations are corrected for the presence of free product.
 6. City of Port Angeles benchmark is located on a fire hydrant northeast of the site along Marine Drive; elevation = 19.80 feet.

Reference: Drawing entitled "General Arrangement, Marine Station, Third & 'A' Streets, Port Angeles, Wash.," by Unocal, revision dated 05/10/90.

	GROUND WATER ELEVATION CONTOUR MAP 10/10/95 FIGURE 2
--	--