



⊕ Approximate location of soil sample

➔ Probable direction of shallow-seated groundwater flow

- - - - - Approximate limits of subject property

**Not To Scale**



|   |                  |   |                                     |
|---|------------------|---|-------------------------------------|
|  <b>ecology and environment, inc.</b><br>International Specialists in the Environment<br>Seattle, Washington |                  | LOWER DUWAMISH WATERWAY<br>RM 2.0-2.3 EAST<br>Seattle, Washington   |                                     |
|   |                  | FACILITY AND PHASE I SITE EXPLORATION MAP -<br>RIVERSIDE INDUSTRIAL PARK<br>(IN OPERATION AS BIG JOHN'S TRUCK REPAIR) |                                     |
| <b>Base Map Reference:</b><br>Environmental Associates, Inc. 1999.  | Date:<br>5-21-08 | Drawn by:<br>AES  | Figure 19<br>10:002330WD1403\fig 19 |

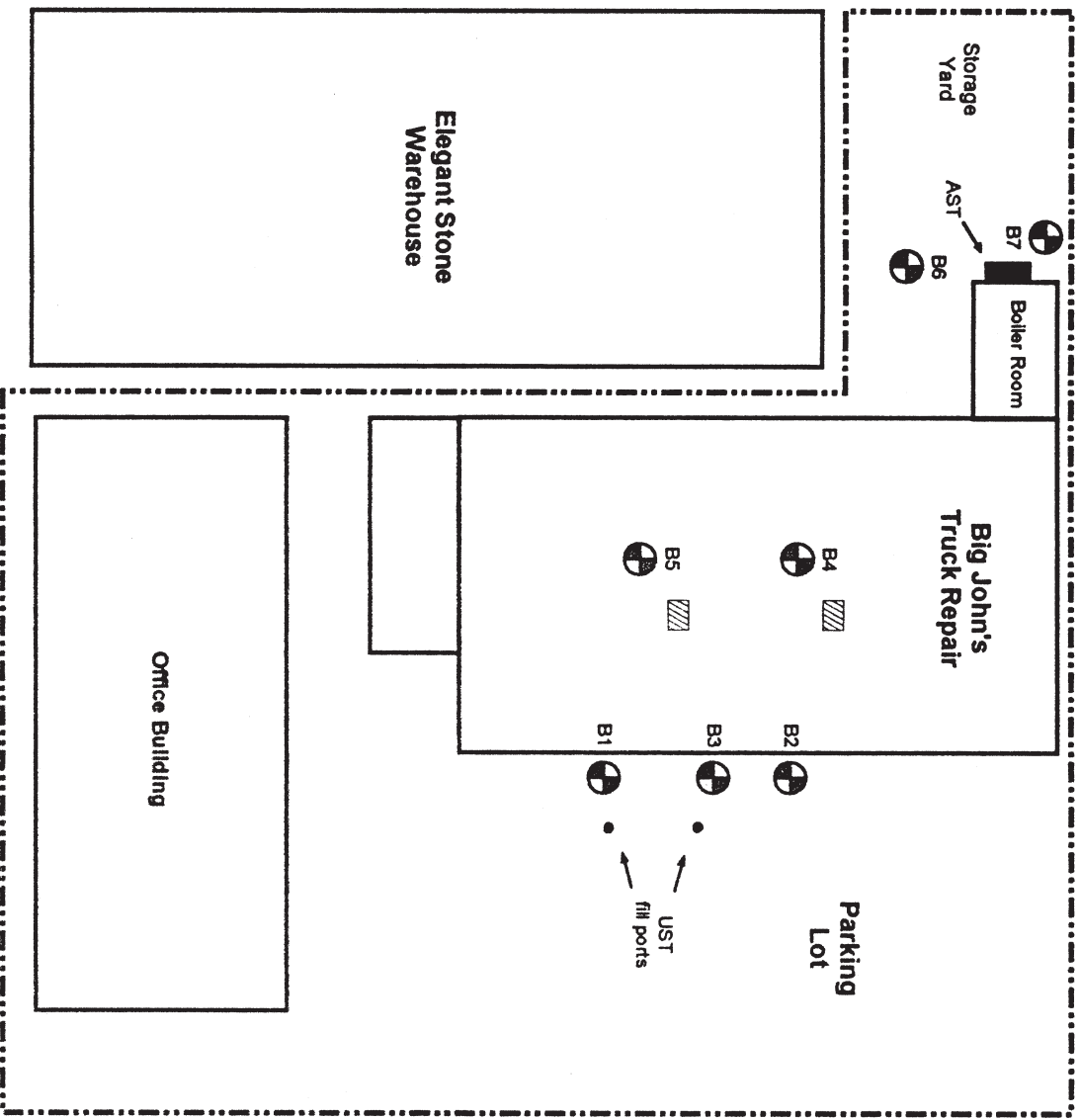

- Legend:**
-  **Approximate Location of Test Borings.**
  -  **Approximate Location of Floor Drains.**
  -  **Probable Direction of Shallow-Seated Groundwater.**

Figure 20

|   |  |  |                  |
|---|--|--|------------------|
|  <b>ecology and environment, inc.</b><br>International Specialists in the Environment<br>Seattle, Washington |  | LOWER DUWAMISH WATERWAY<br>RM 2.0-2.3 EAST<br>Seattle, Washington  |                  |
|   |  | 1998 PHASE II SUBSURFACE EXPLORATION MAP -<br>RIVERSIDE INDUSTRIAL PARK<br>(IN OPERATION AS BIG JOHN'S TRUCK REPAIR) |                  |
| <b>Base Map Reference:</b><br>Geotech Consultants 1998.   |  | Date:<br>5-21-08   | Drawn by:<br>AES |
|   |  | 10:002330WD\403\fig 20   |                  |

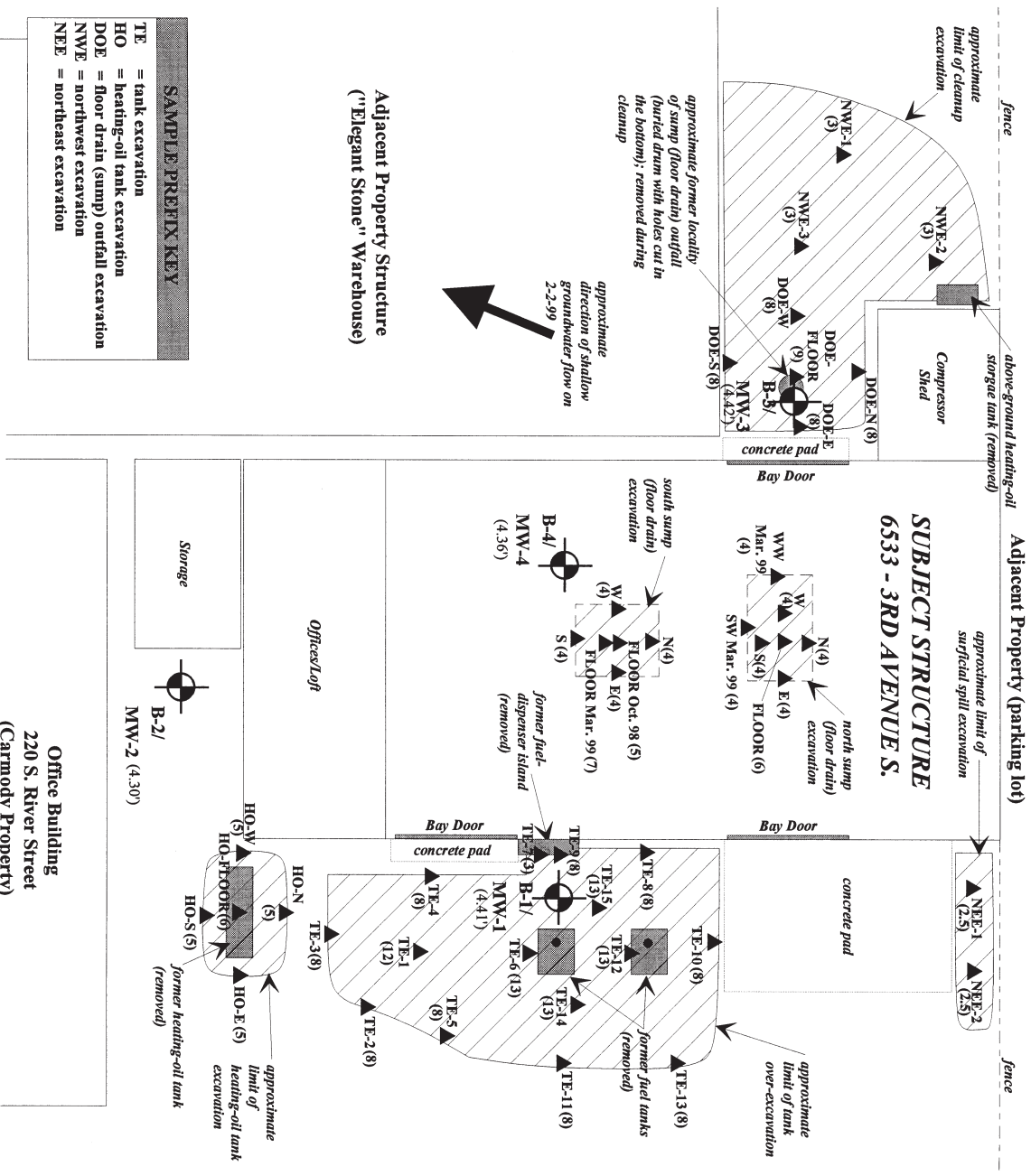

| SAMPLE PREFIX KEY |   |
|-------------------|---|
| TE                | = tank excavation                       |
| HO                | = heating-oil tank excavation           |
| DOE               | = floor drain (sump) outfall excavation |
| NWE               | = northwest excavation                  |
| NEE               | = northeast excavation                  |

**TE-5 (8)** ▲ = Approximate location of soil sample following excavation of contaminated soil (depth of sample in feet below the ground surface shown in parenthesis).

**B-1** ⊕ = Approximate location of boring/monitoring well by EAI on 2-1-99 (relative elevation of groundwater table as measured on 2-2-99 shown in parenthesis).

**MW-1** ⊕ (4.41)

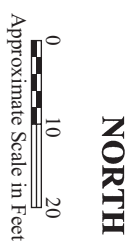

**ecology and environment, inc.**  
International Specialists in the Environment  
Seattle, Washington

**Figure 21**

LOWER DUWAMISH WATERWAY  
RM 2.0-2.3 EAST  
Seattle, Washington

TANK REMOVAL AND SAMPLING LOCATIONS -  
RIVERSIDE INDUSTRIAL PARK  
(IN OPERATION AS BIG JOHN'S TRUCK REPAIR)

**Base Map Reference:**  
Environmental Associates, Inc. 1999.

Date: 5-21-08  
Drawn by: AES

10:002330WD\403\fig 21

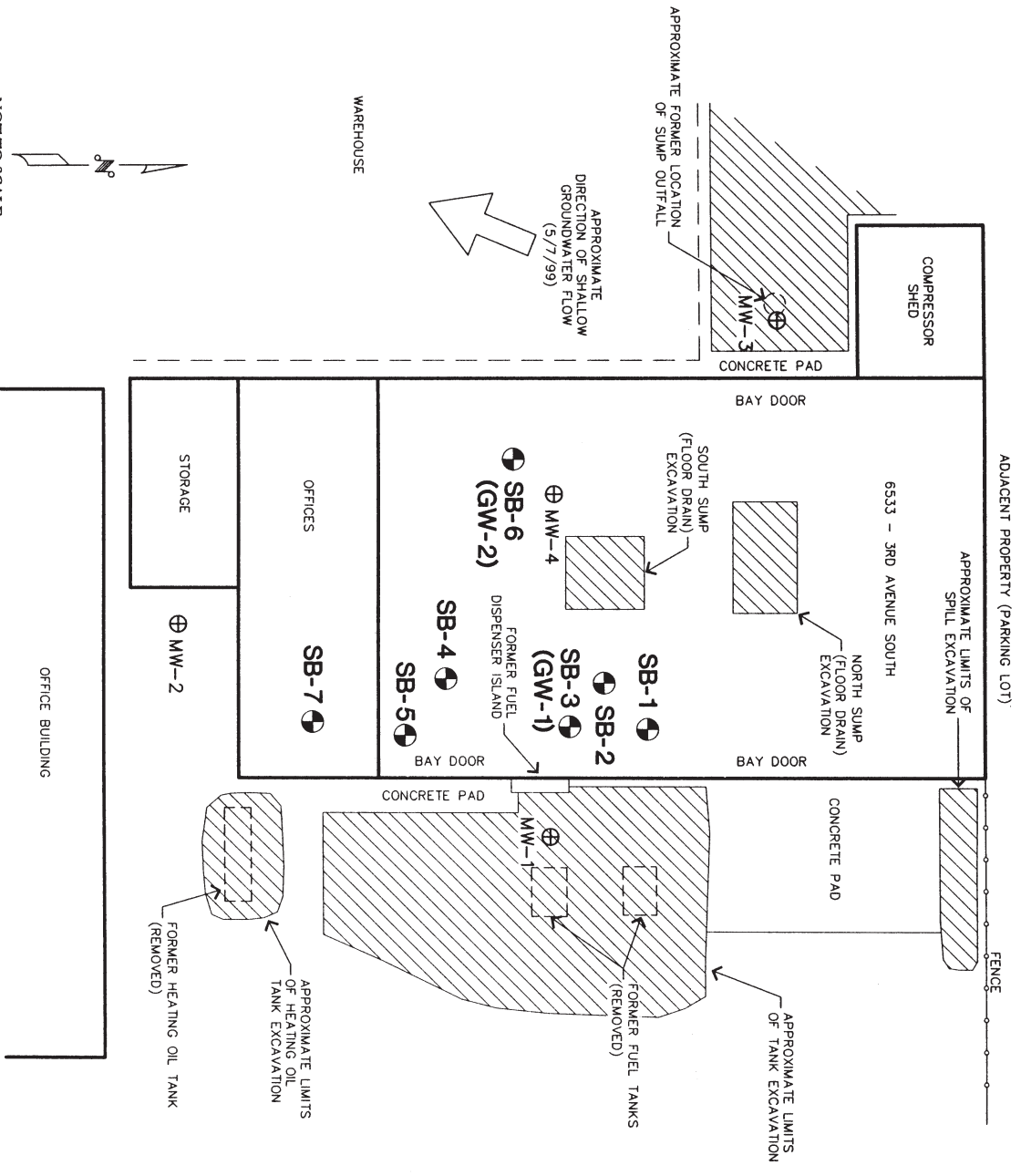

- LEGEND**
- ⊕ MW-1 APPROXIMATE LOCATION OF MONITORING WELL BY OTHERS
  - ⊕ SB-1 SOIL BORING LOCATION BY PBS ENVIRONMENTAL (6/99)
  - [Hatched Box] FORMER EXCAVATION

**ecology and environment, inc.**  
International Specialists in the Environment  
Seattle, Washington

LOWER DUWAMISH WATERWAY  
RM 2.0-2.3 EAST  
Seattle, Washington

1999 PHASE II SUBSURFACE EXPLORATION MAP -  
RIVERSIDE INDUSTRIAL PARK  
(IN OPERATION AS BIG JOHN'S TRUCK REPAIR)

**Base Map Reference:**  
PBS Environmental 1999.

Date: 5-21-08

Drawn by: AES  
10:002330WD1403\fig 22

Figure 22

